



National Kaohsiung
CENTER FOR THE ARTS

WEI WU YINGGE

衛武營 國家藝術文化中心

國家表演藝術中心 National Performing Arts Center

戲劇院

PLAYHOUSE

技術製作資訊

Production Technical Information

Table of Contents

| | |
|--|----|
| 0 General Information | 1 |
| 0-1 National Kaohsiung Center for the Arts (WeiWuYing) | 1 |
| 0-2 PlayHouse | 1 |
| 0-3 Traffic Information | 2 |
| 0-4 Contact Information | 2 |
| 0-5 Stage door | 2 |
| 0-6 Auditorium / Seats | 3 |
| 0-7 Plan | 4 |
| 0-8 Section | 6 |
| 1 Stage | 7 |
| 1-1 Stage | 7 |
| 1-2 Elevation Platform / Stage Traps | 8 |
| 1-3 Traps | 11 |
| 1-4 Tension Grid | 11 |
| 1-5 Fly | 12 |
| 1-6 Hoisting | 13 |
| 1-7 Curtain and Others | 14 |
| 1-8 Fly Bar List | 15 |
| 2 Lighting | 17 |
| 2-1 Lighting instrument | 17 |
| 2-2 Accessories | 18 |
| 2-3 Lighting Circuit | 20 |
| 2-4 Portable Lift | 26 |
| 2-5 Additional Power Supply | 26 |
| 2-6 House Light / Working Light / Blackout | 26 |
| 3 Audio/Video-Systems | 27 |
| 3-1 Audio Facilities | 27 |
| 3-2 Control Room | 27 |
| 3-3 Stage Manager' s Console | 27 |
| 3-4 Machine Room | 27 |
| 3-5 Microphone | 28 |
| 3-6 Communications | 28 |
| 3-7 Locations of Communications | 29 |
| 3-8 Stage Cameras and Video Surveillance Systems | 29 |
| 3-9 Paging Systems | 30 |
| 3-10 Projector | 30 |
| 3-11 Projector connections | 30 |
| 3-12 Subtitle | 30 |
| 4 Backstage | 31 |
| 4-1 Dressing Room and Green Room | 31 |
| 4-2 Orchestra Facilities | 31 |
| 4-3 Pianos (shared between four theatres) | 31 |
| 4-4 Loading Dock / Scenery Shipping Path / Loading Flow | 32 |
| 4-5 Other Facilities | 34 |

Last updated: 2018/09/26

0 General Information

0-1 National Kaohsiung Center for the Arts (WeiWuYing)

CENTER FOR THE ARTS, ARTS FOR THE PEOPLE , National Kaohsiung Center for the Arts will become one of the important theatre complexes of the international art field. It include four performance blocks, the 2,260-seat Opera House, the 2,000-seat Concert Hall, the 1,254-seat PlayHouse and the 470-seat Recital Hall.



0-2 PlayHouse

The Playhouse is a space mainly used for various drama and dance performances. The stage can be configured into proscenium or thrust stage. The thrust stage design shortens the distance between the audience and performers, so that the audience can perceive the emotions of the performers at close proximity.



0-3 Traffic Information

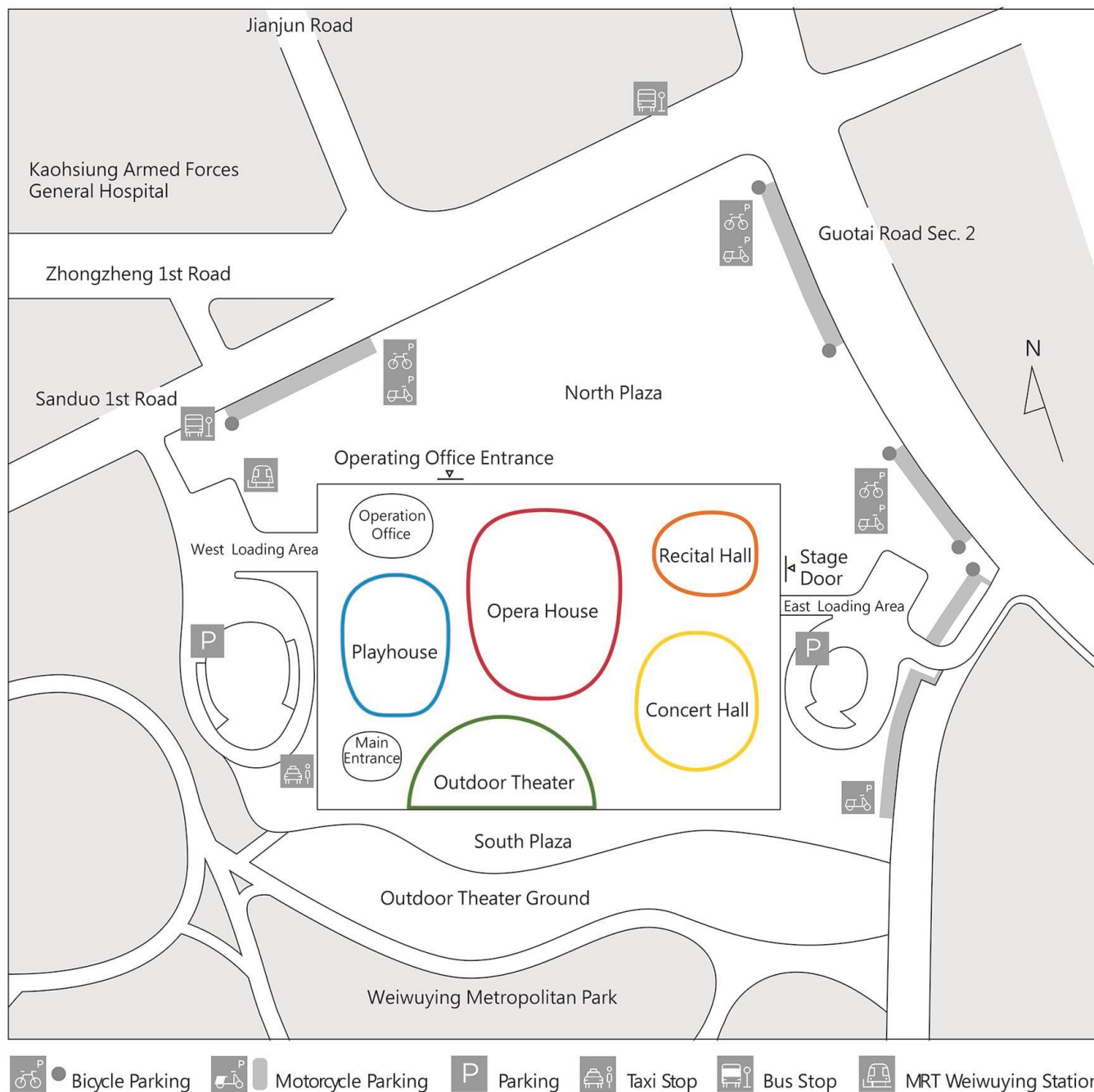

0-4 Contact Information

National Kaohsiung Center for the Arts (WeiWuYing)

No.1, Sanduo 1st Rd., Fengshan Dist.,
Kaohsiung City 83075, Taiwan

+886 7-262-6666

service@npac-weiwuying.org

0-5 Stage door

Ground floor access is from the north and east side of building. Enter from Operating office entrance on Sanduo 1st Road or Stage Door on Guotai Road.

Basement Level 1 access is from Sanduo 1st Road entrance for Opera House and Playhouse ,Guotai Road entrance for Concert Hall and Recital Hall.

Working pass will be required for entry.

0-6 Auditorium / Seats

Capacities: 1210 seats

First floor: 382 seats, including 2 working seats, 164 seats for Elevation Platforms No.1~7, and 48 seats for Chinese Orchestra Pit.

No.1 Elevation Platform (Row 1, No.1~23 / Row 2, No.1~24): 47 seats

No.2 Elevation Platform (Row 3, No.1~23): 23 seats

No.3 Elevation Platform (Row 4, No.1~22): 22 seats

No.4 Elevation Platform (Row 5, No.1~21): 21 seats

No.5 Elevation Platform (Row 6, No.1~18): 18 seats

No.6 Elevation Platform (Row 7, No.1~17): 17 seats

No.7 Elevation Platform (Row 8, No.1~16): 16 seats

Chinese Orchestra Pit (Row 9, No.22~40 / Row 10, No.24~44 / Row 11, No.26~48 / Row 12, No.28~56): 48 seats

Second floor: 557 seats, including 10 wheelchair seats, 2 working seats, and 16 seats for Auditorium Control Area.

Auditorium Control Area (Row 17, No.1~8 / Row 18, No.1~8): 16 seats

Third floor: 271 seats, including 3 wheelchair seats.

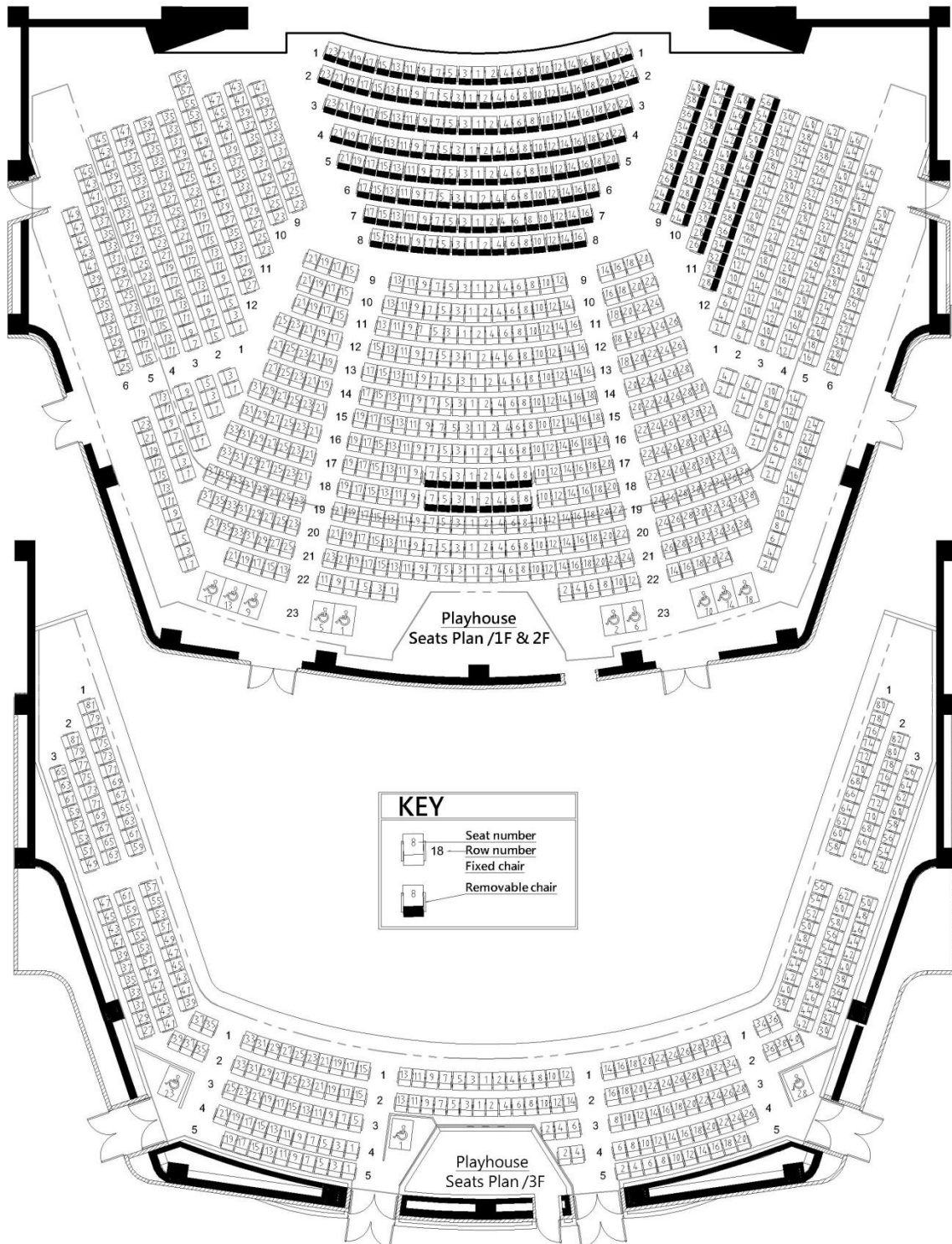

Figure 0.1- Seats plan

2018/06/26 OH V1

0-7 Plan

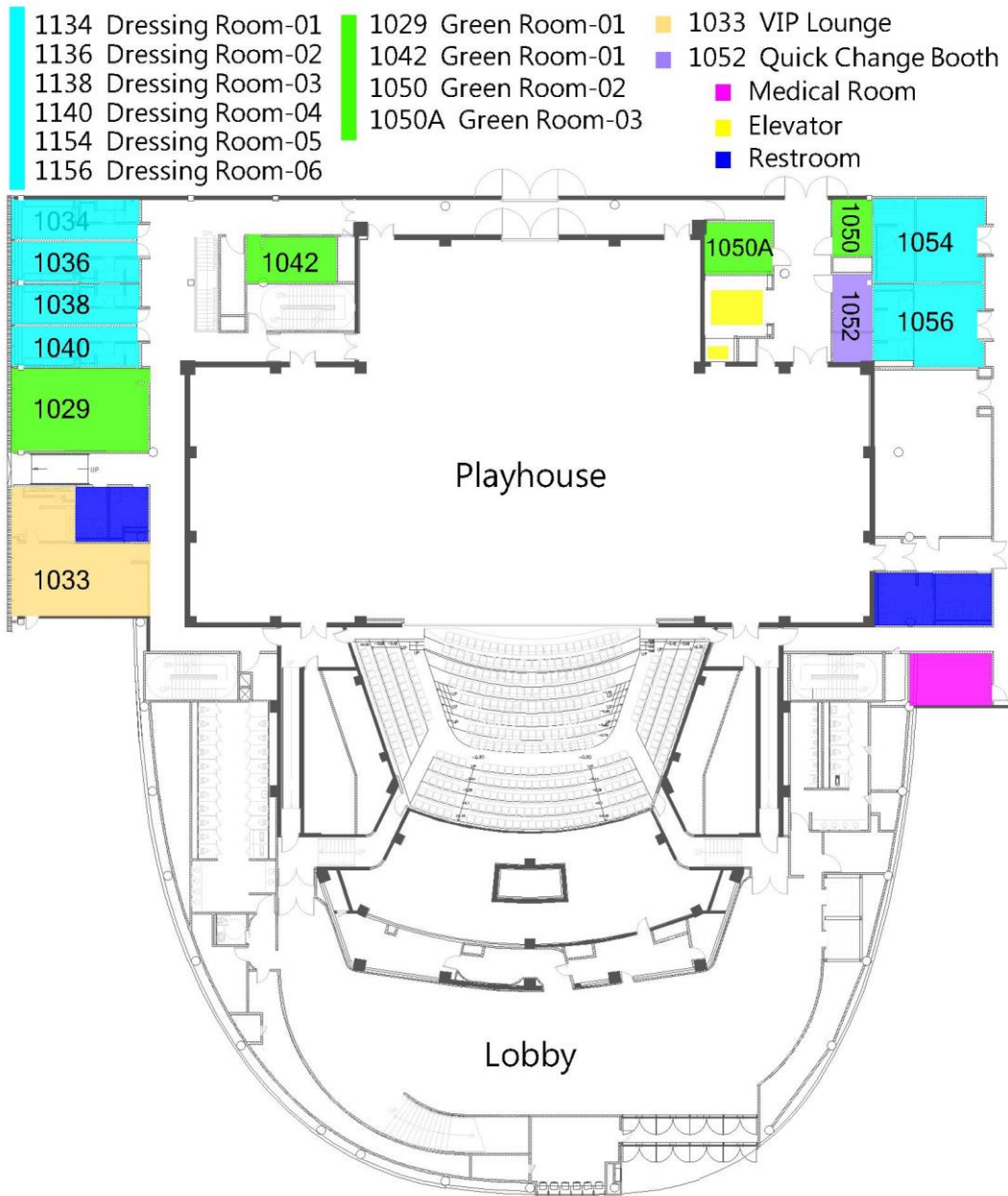

Figure 0.2- Playhouse 1F Plan

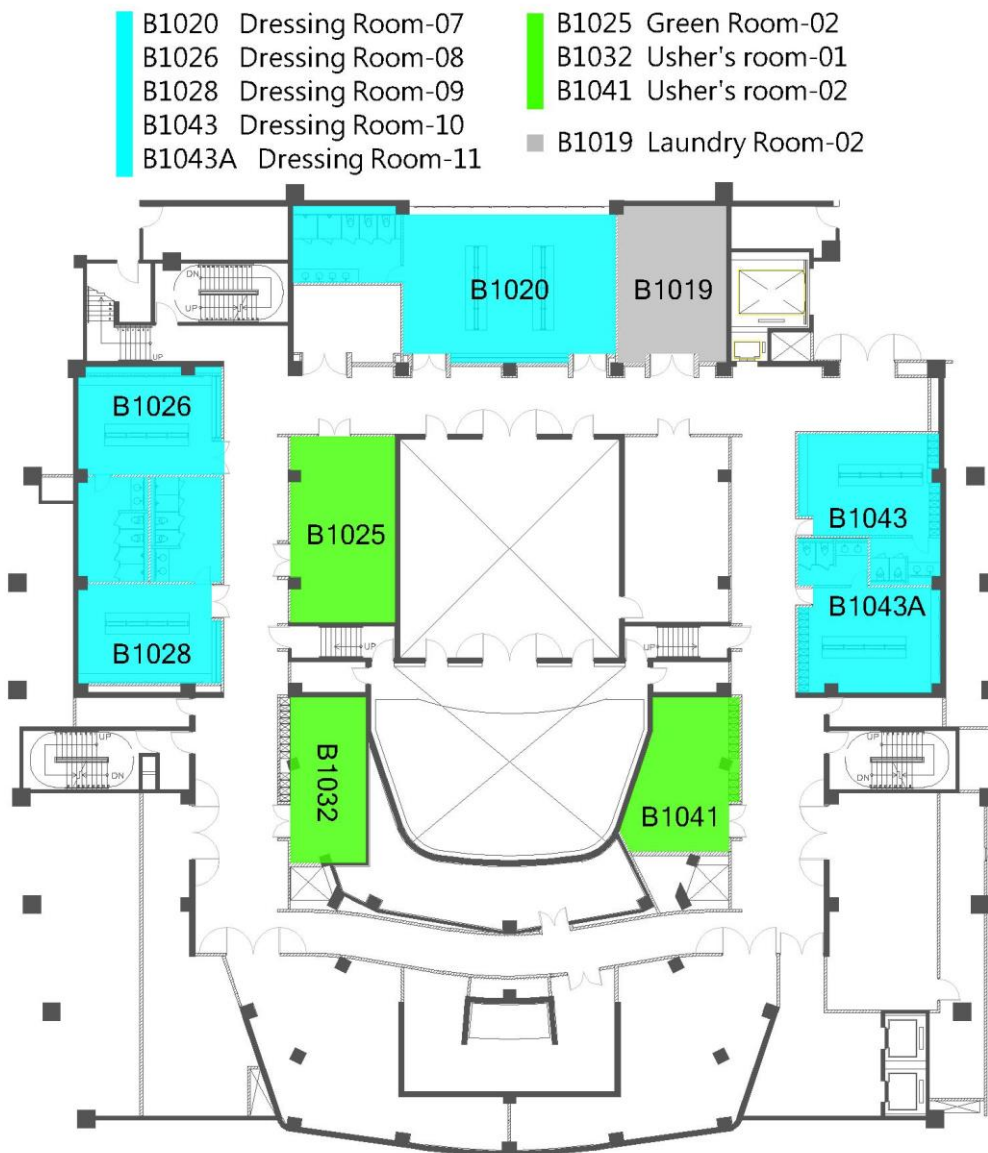

Figure 0.3- Playhouse B1 Plan

0-8 Section

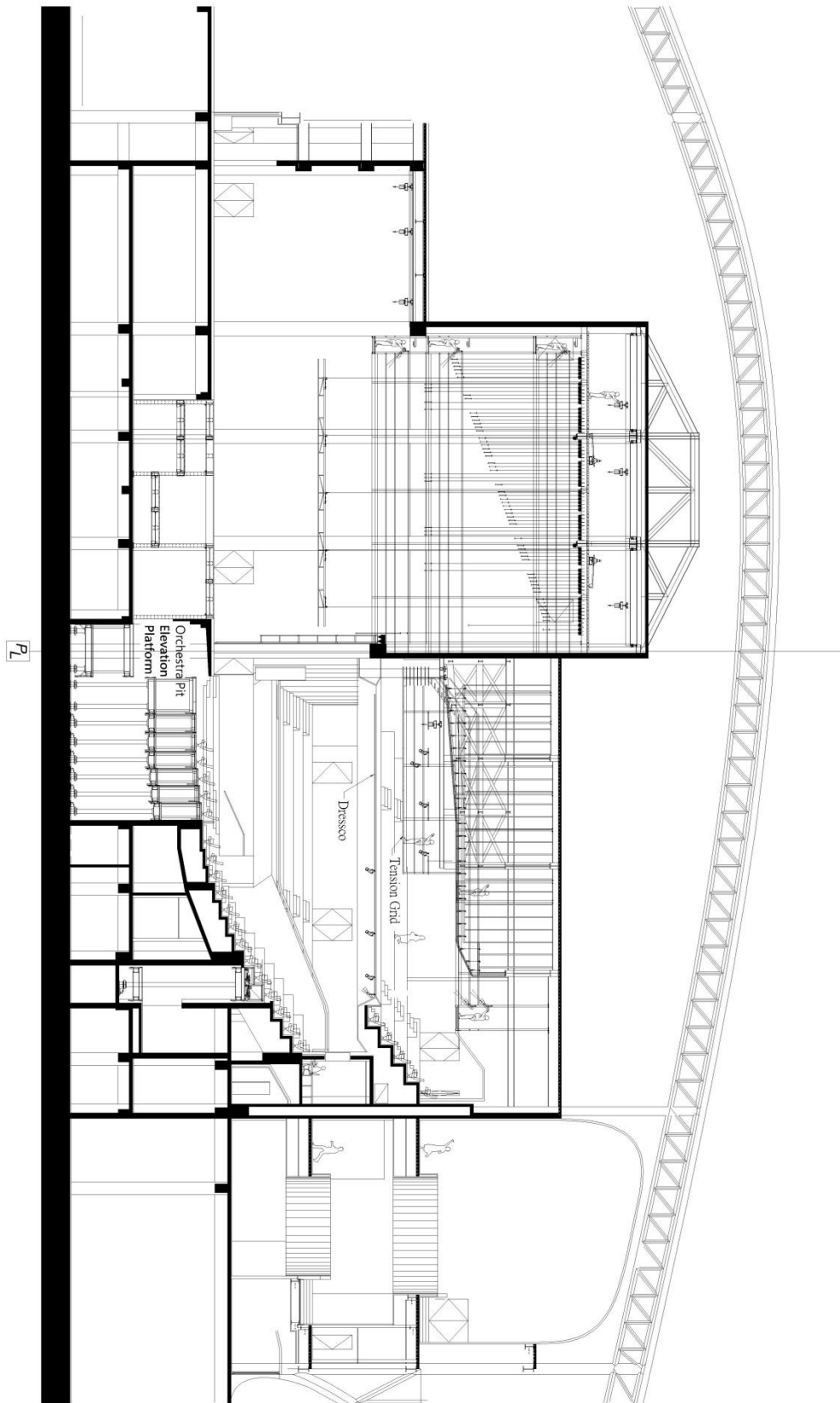

Figure 0.4- Playhouse Section

1 Stage

1-1 Stage

1-1-1 Floor

Black painted composite wood stage floor;The production scenery can secure to the deck by screws but no nails in part of stage area. Please contact the technical service for more detail.

The trap area is made of Okoume hardwood plywood, the surface is prohibited from nailing and locking.

The main stage ,side stage ,rear stage ,pit elevation platform, the auditorium elevation platform is made of Pitch pine, the stage surface can be locked with screws, and can not be drilled.

1-1-2 Tormentor

Proscenium size : 18m (width) x 8m (height)

Proscenium opening: 12m to 18m (width)

Apron to PL: 1.8m

1-1-3 Stage Dimensions

Main stage: 27.2m (width) x 16.2m (depth) x 20.5m (height) (from stage surface to under above grid beams)

Rear stage: 22.3m (width) x 10m (depth) x 11m (height)(8.5m height from stage surface to under gallery)

Side stage: 10.2m (width) x 16.2m (depth) x 11m (height) (8.5m height from stage surface to under gallery)

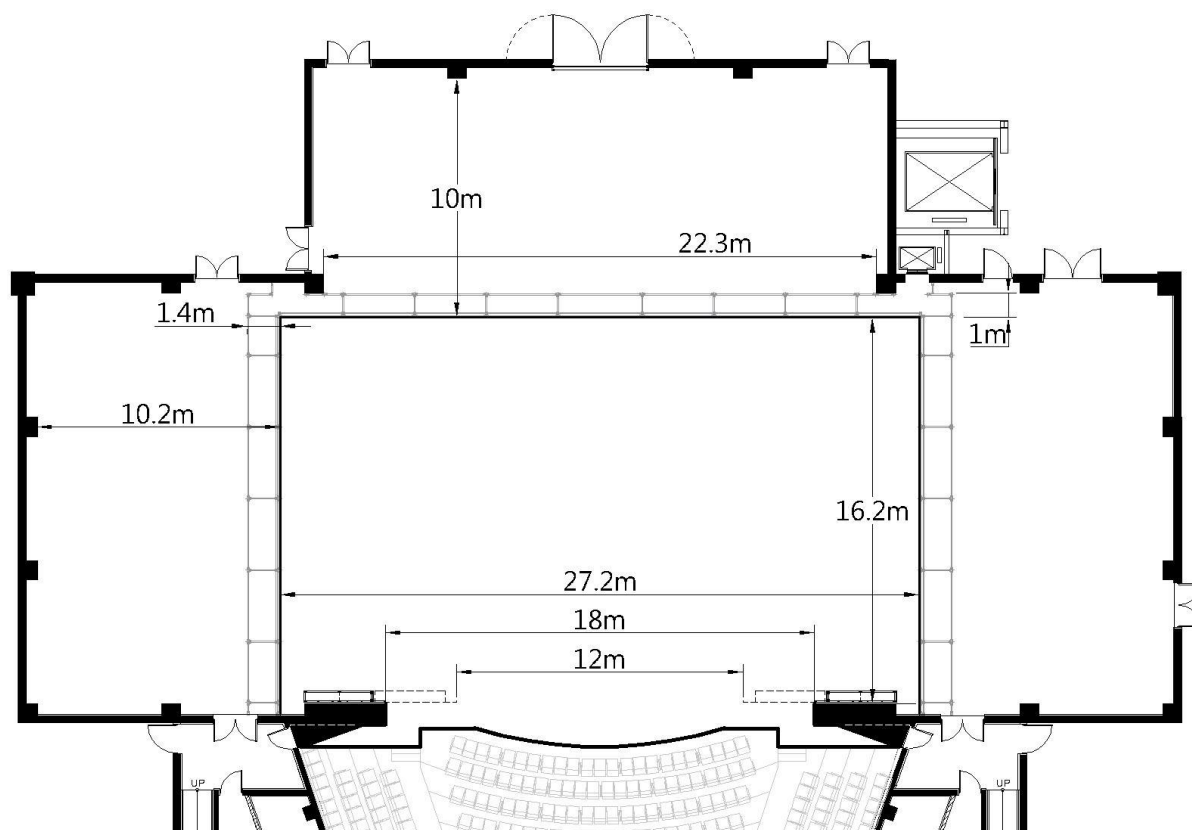

Figure 1.1- Stage Plan

1-2 Elevation Platform / Stage Traps

1-2-1 Orchestra Pit

Orchestra pit may combined with elevation platform No.1 and 2 ,as the extend.

Amount: 1 row, arc shape platform

Size: 15m (width) x 2.85m (depth), 38.5 m²

Elevation: -4.5m to -2.25m

Capacity

Dead load : 750kg/ m²

Live load : 500kg/ m²

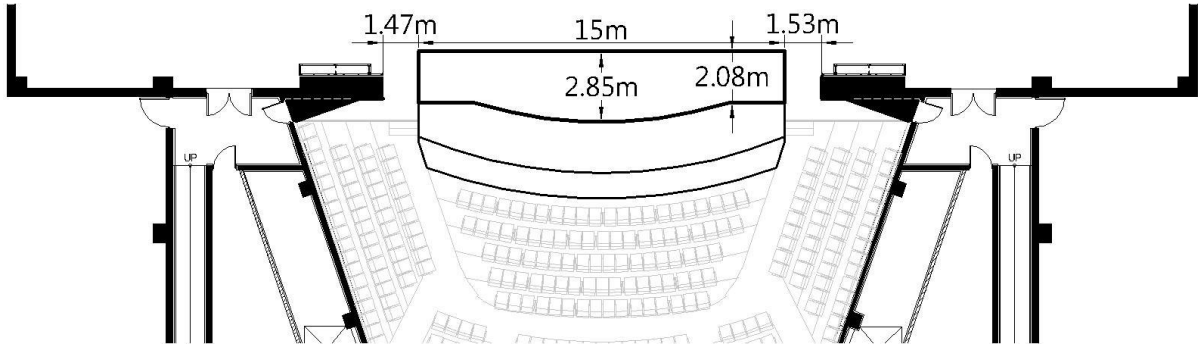

Figure 1.2.1.1- Orchestra Pit Elevation Platform location plan

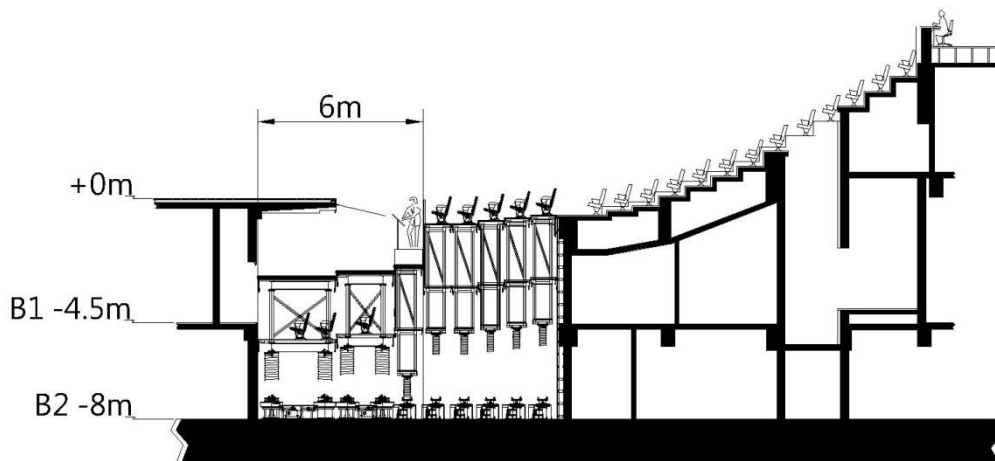

Figure 1.2.1.2- Orchestra Pit Elevation Platform Section

1-2-2 Elevation Platform

Elevation Platforms can be adjust for different function, as auditorium, thrust stage and extend orchestra pit (No.1 ~ 2) by need.

- No.1, 15 m (width) x 2.1m (depth), 31.2 m²
- No.2, 15m (width) x 1.05m (depth), 16 m²
- No.3, 14.6m (width) x 1.05m (depth), 15 m²
- No. 4, 13.8m (width) x 0.95m (depth), 12.7 m²
- No.5, 13m (width) x 0.95m (depth), 11.9 m²
- No.6, 12.3m (width) x 0.95m (depth), 11.2 m²
- No.7, 11.6m (width) x 1m (depth), 9.9 m²

Elevation

- No.1 / No.1: -4.5m to 1.65m
- No.3~ No.7: -2.25m to 1.65m

Capacity

- Dead load : 750kg/ m²
- Live load : 500kg/ m²

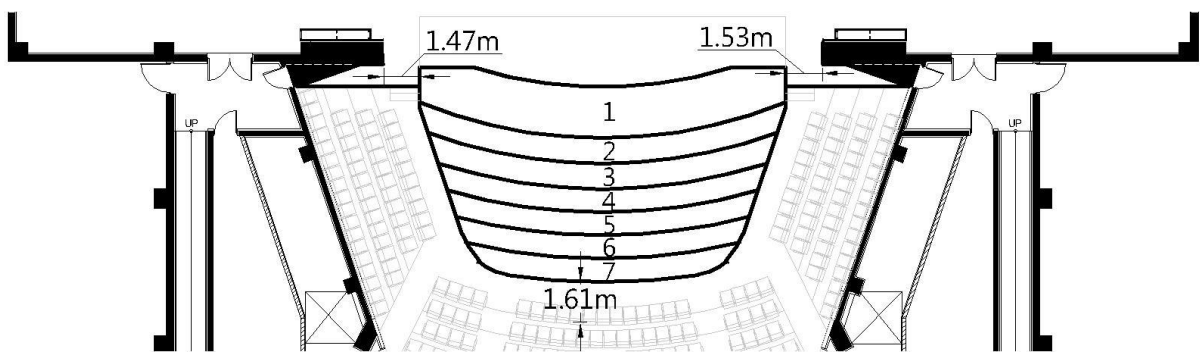

Figure 1.2.2- Elevation Platform location plan

1-2-3 Chinese Orchestra Pit (Side Auditorium Platform)

SAP-1: 8m (width) x 0.95m (depth), 6.9 m²

SAP-2: 9.25m (width) x 0.95m (depth), 8 m²

SAP-3: 10.6m (width) x 1m (depth), 9.6 m²

Elevation

SAP-1 / SAP-2: -0.6m to ±0.0m

SAP-3: -0.6m to 0.2m

Capacity:

Dead load : 750kg/ m²

Live load : 500kg/ m²

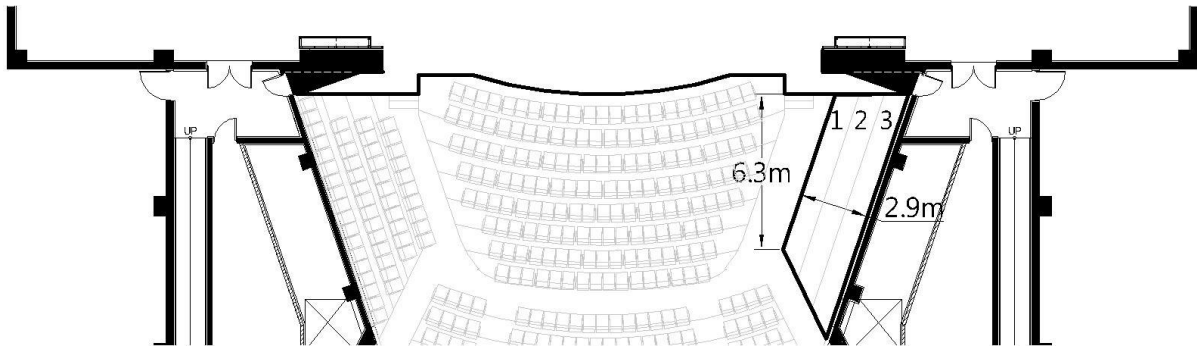

Figure 1.2.3- Chinese Orchestra Pit (Side Auditorium Platform) location plan

1-2-4 Auditorium Control Area

16 Seats, No.1~8, Row 17 ~18

For large equipment, please enter the platform from B1 floor.

Size: 4.7m (width) x 2.1m (depth), 9.87 m²

Elevation: -4m (B1) to 2.8m

Capacity

Dead load : 500kg/ m²

Live load : 250kg/ m²

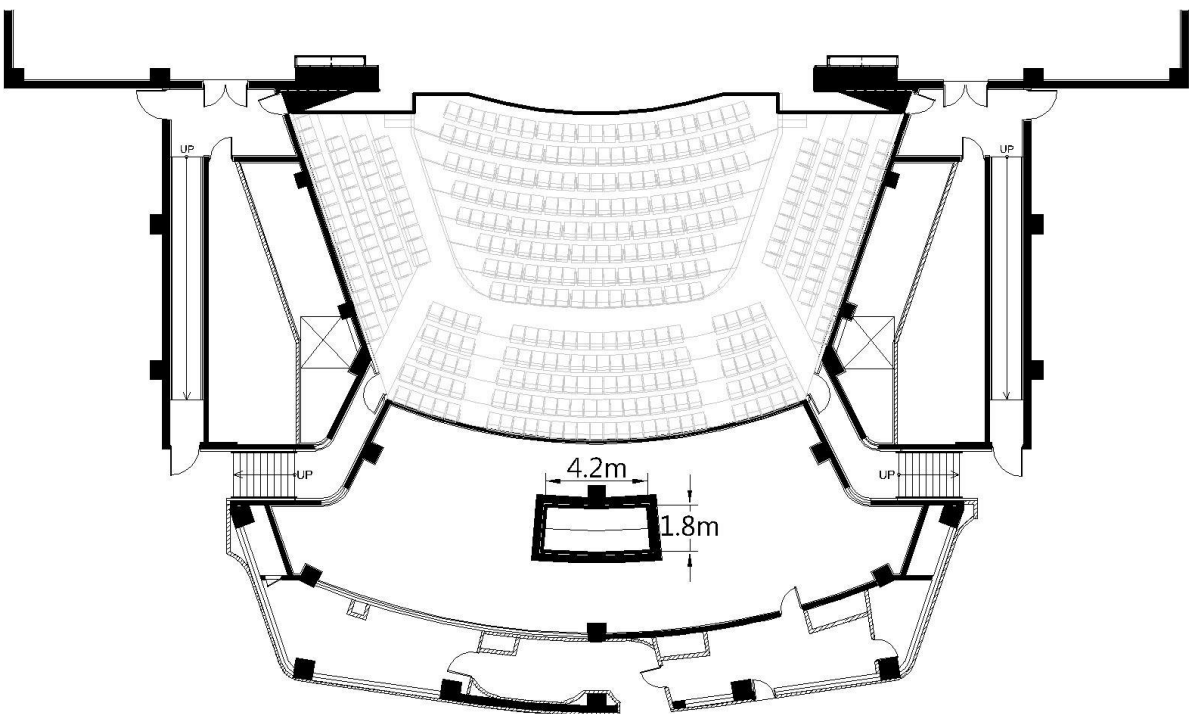

Figure 1.2.4- Auditorium Control Area location plan

1-3 Traps

72 pieces individual trap door
 Size: 11.4m x 11.4m / 0.95m (width) x 1.9m (depth) each
 Capacity: 750kg/ m², average
 Distance to PL : 1.87m

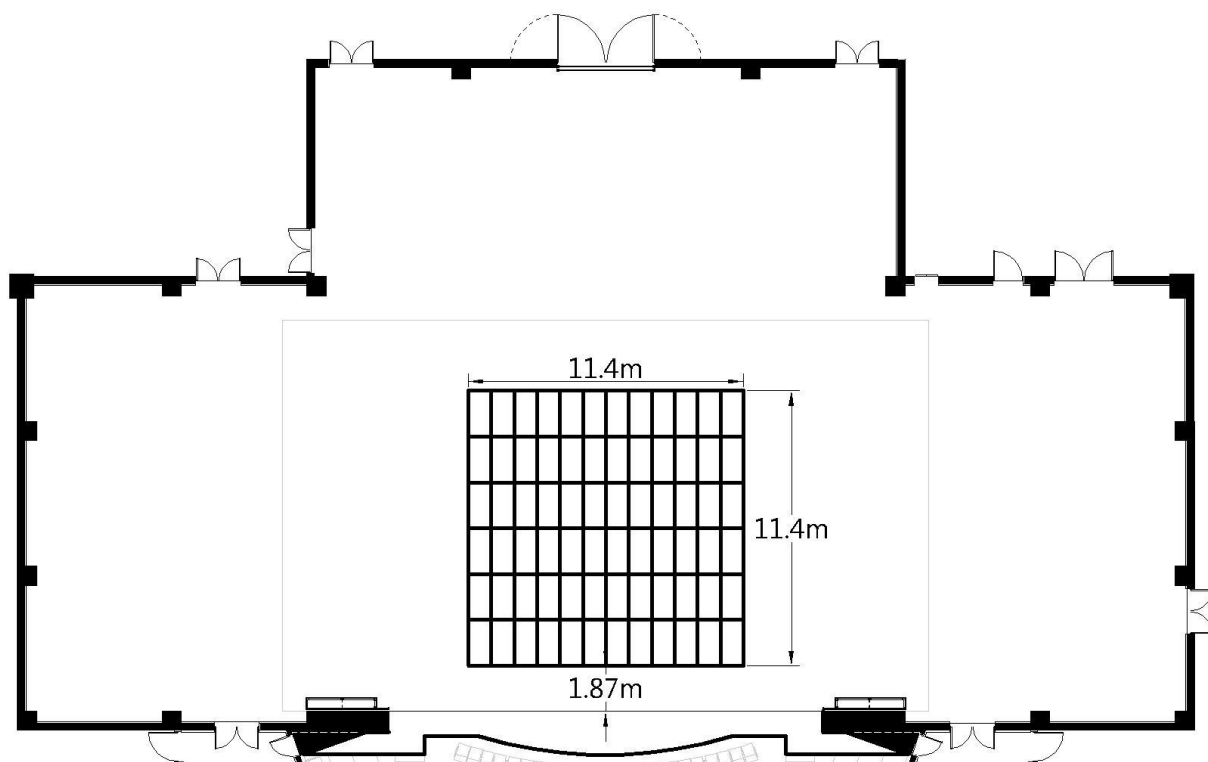

Figure 1.3- Stage Traps location plan

1-4 Tension Grid

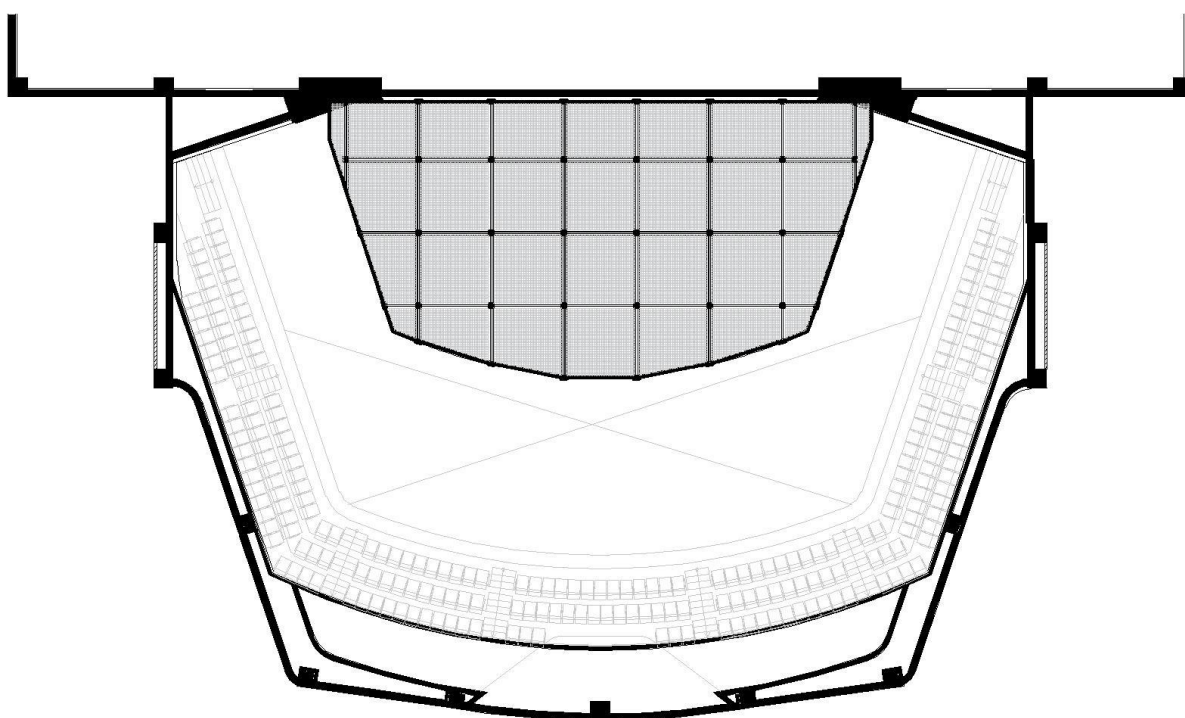

Figure 1.4- Tension Grid location plan

1-5 Fly

1-5-1 Controller

Waagner Biro CAT120、CAT190、CAT192

1-5-2 Fly bars

22m (length), 4.8cm (diameter), +0.5cm to 19m, 67 sets

House Curtain, guillotine / traveller, 24m (length), 1.1m from PL, Speed: 0.24~1.8M/S

Side Fly Bar 1, 14.4m, 11.8m from CL, +0.05cm to 19m

Side Fly Bar 2 / 3, 14.9m, 12.2 / 12.6 from CL, +0.05cm to 19m

Safe load

0.5 m/s : 750kg

1.0 m/s : 500kg

2.0 m/s : 350kg

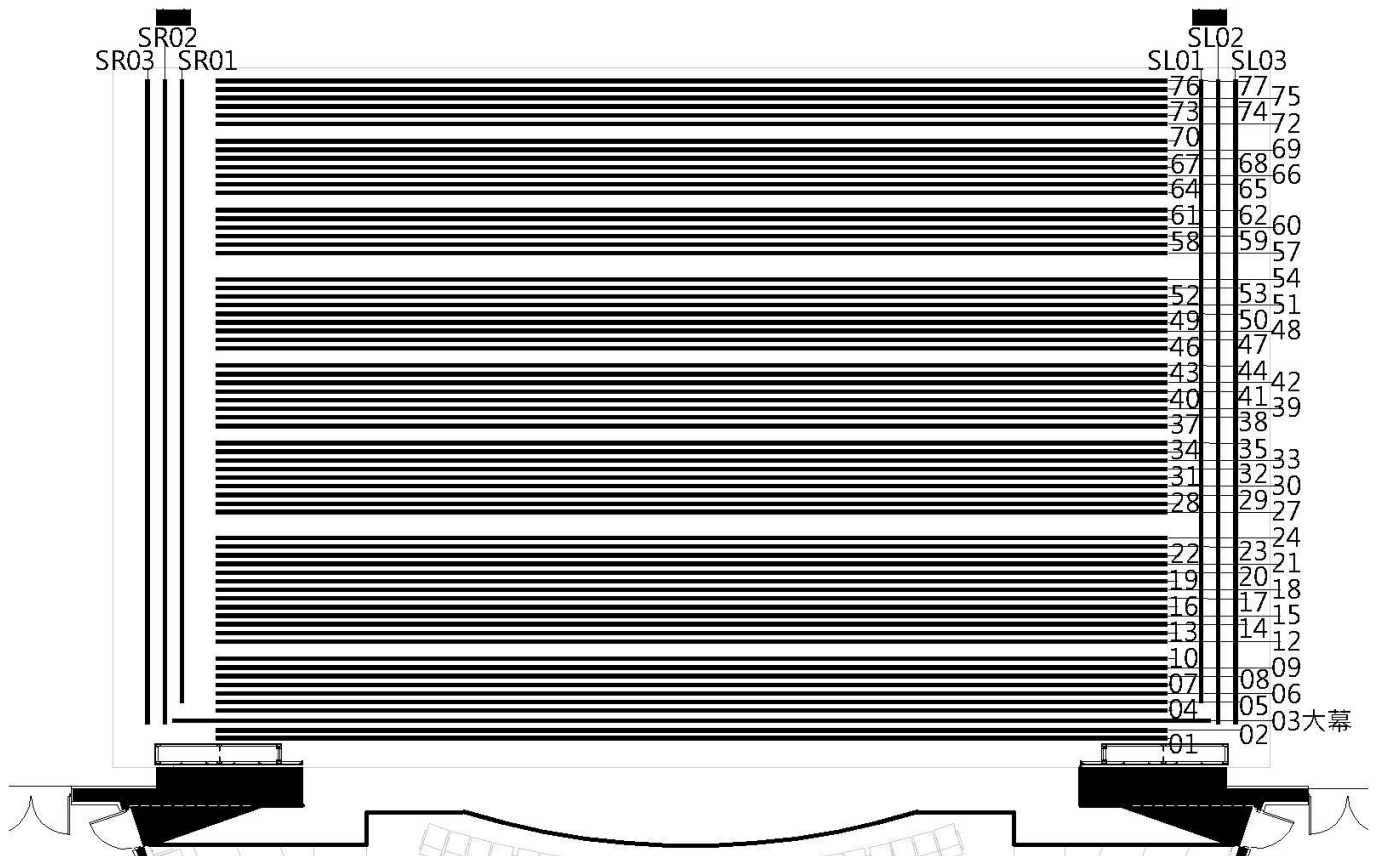

Figure 1.5- Fly Bars Plan

1-6 Hoisting

1-6-1 Point Hoist (load 250kg)

8 sets, winch line length 31.2m, lifting speed: 0 to 1.8m/s

Operation range: available for using grid area. Boundless except for Fly Bars operation space.

1-6-2 Chain Hoist with Trolley (load 1000kg, fixed speed: 9.6m/min)

Grid: 12 sets, operation length 28m (Boundless except for Fly Bars operation space)

Side stage: 6 sets, operation length 12m

Rear stage: 12 sets, operation length 12m

Tension Grid: 5 sets, operation length 21m

1-6-3 Hoist for Subtitle Display (load 500kg)

2 sets, operation length 15m, lifting speed: 0 to 0.5m/s

Load

1.0 M/S² : 500 公斤

2.0 M/S² : 350 公斤

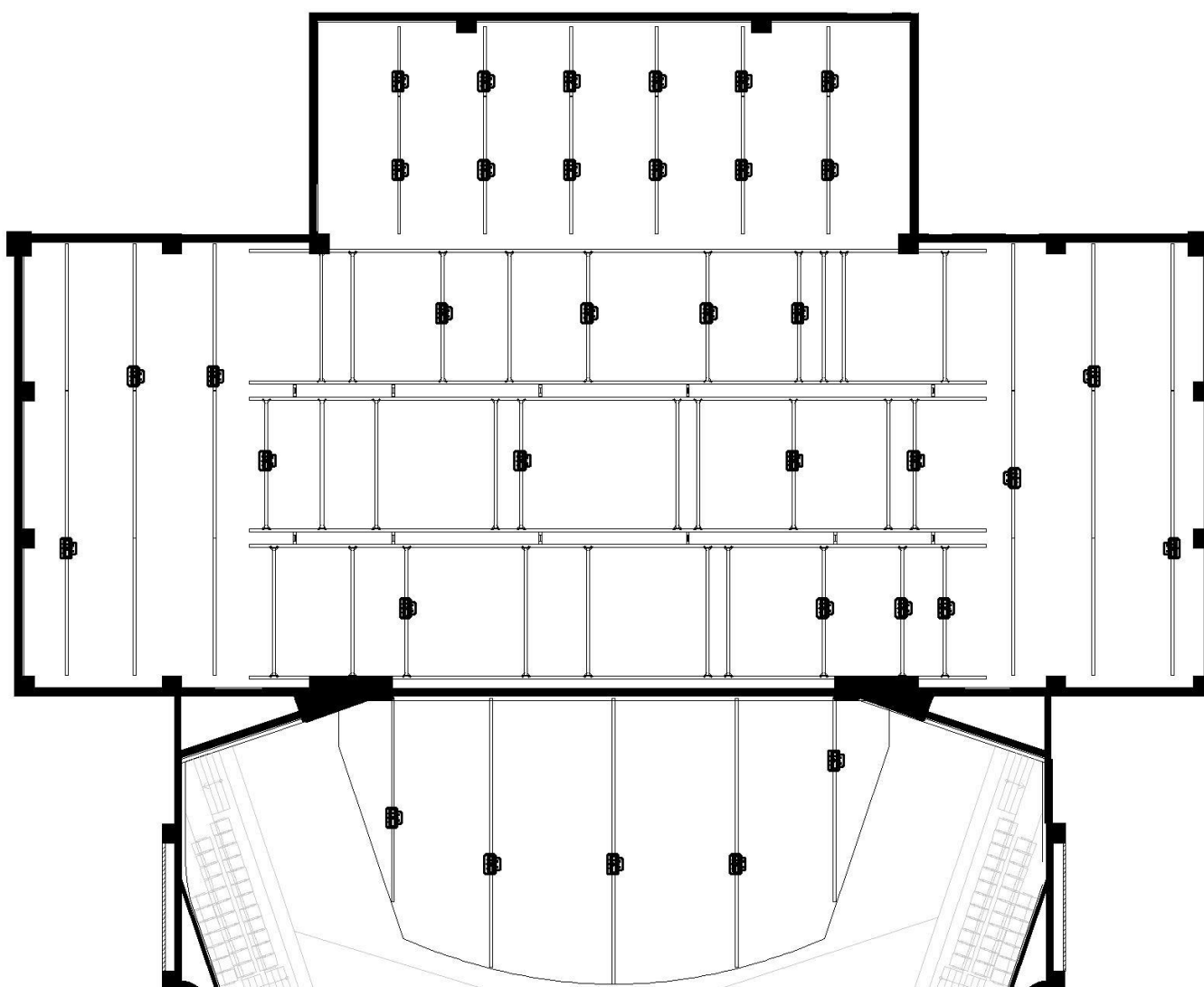

Figure 1.6- Chain Hoisting plan

1-7 Curtain and Others

| Item Number | Product Name | Quantity | Notes (unit: meter) |
|-------------|--|----------|---|
| 01 | House Curtain | 1 pair | 10 x 12.9 ShowTex –Paris CS (Black color) |
| 02 | Border | 8 | 3.5 x 22 ShowTex –Bellini |
| 03 | Leg | 10 | 9 x 2.7 ShowTex –Bellini |
| 04 | Leg | 10 | 9 x 4 ShowTex –Bellini |
| 05 | Tab | 8 | 8.8 x 3 ShowTex –Bellini |
| 06 | White Scrim | 1 | 10 x 22 ShowTex –GobelinTulle (sharks tooth 06 point) |
| 07 | Black Scrim | 1 | 10 x 22 ShowTex – Carre' Tulle (sharks tooth 08 point) |
| 08 | Black Scrim | 1 | 10 x 22 ShowTex –Tulle Aymond (Vision Gauze) |
| 09 | Cyclorama (Rear Projection Screen) | 1 | 9 x 22 ShowTex – Retro Screen Grey plus |
| 10 | Cotton Cyclorama | 1 | 9 x 22 ShowTex –Cyclo 270 |
| 11 | Black Backdrop | 1 | 9 x 22 ShowTex –Bellini |
| 12 | Wooden Sprung Floor 2m*1m | 152pc | 1.Shared with Opera House 2.Area (installation area adjustable) 20m x 16m, built-up, portable with latch, wooden plywood with high density mitigation block, 3.7 cm (depth),point load 1000kg, average shock-absorbing ability 65 % |
| 13 | Wooden Sprung Floor 1m*1m | 16pc | |
| 14 | Black Dance Floor For Wooden Floor only | 8 rolls | 1.Shared with Opera House 2.20m (length) x 2m (width) x 2mm (depth) |
| 15 | Black and Gray Dance Floor | 21 olls | 1.Shared with Opera House 2.20m (length) x 2m (width) x 1.7mm (depth) |
| 16 | Black and White Dance Floor | 20 olls | 1.Shared with Opera House 2.24m (length) x 1m (width) x 1.8mm (depth) |
| 17 | Black and Gray Dance Floor | 21 olls | 1.Shared with Opera House 2.22m (length) x 0.95m (width) x 1.8mm (depth) |

1-8 Fly Bar List

| Bar Number | Distance to PL | Content | Length | Note |
|------------|----------------|-----------------------------|---------------------|------------------------|
| 0 | 0 | Plaster Line | | |
| 1 | 67 | | 2200 | |
| 2 | 87 | | 2200 | |
| 3 | 110 | House Curtain (Black color) | 2400(1000hx1290w*2) | guillotine / traveller |
| 4 | 133 | | 2200 | |
| 5 | 152 | | 2200 | |
| 6 | 171 | | 2200 | |
| 7 | 190 | | 2200 | |
| 8 | 212 | | 2200 | |
| 9 | 232 | | 2200 | |
| 10 | 251 | | 2200 | |
| 12 | 292 | | 2200 | |
| 13 | 312 | | 2200 | |
| 14 | 330 | | 2200 | |
| 15 | 353 | | 2200 | |
| 16 | 373 | | 2200 | |
| 17 | 392 | | 2200 | |
| 18 | 410 | | 2200 | |
| 19 | 433 | | 2200 | |
| 20 | 452 | | 2200 | |
| 21 | 471 | | 2200 | |
| 22 | 492 | | 2200 | |
| 23 | 512 | | 2200 | |
| 24 | 529 | | 2200 | |
| 27 | 593 | | 2200 | |
| 28 | 612 | | 2200 | |
| 29 | 633 | | 2200 | |
| 30 | 651 | | 2200 | |
| 31 | 673 | | 2200 | |
| 32 | 692 | | 2200 | |
| 33 | 711 | | 2200 | |
| 34 | 733 | | 2200 | |
| 35 | 751 | | 2200 | |
| 37 | 792 | | 2200 | |
| 38 | 812 | | 2200 | |
| 39 | 833 | | 2200 | |
| 40 | 853 | | 2200 | |
| 41 | 872 | | 2200 | |
| 42 | 890 | | 2200 | |
| 43 | 915 | | 2200 | |
| 44 | 931 | | 2200 | |
| 46 | 970 | | 2200 | |
| 47 | 991 | | 2200 | |
| 48 | 1013 | | 2200 | |
| 49 | 1031 | | 2200 | |
| 50 | 1051 | | 2200 | |
| 51 | 1069 | | 2200 | |
| 52 | 1092 | | 2200 | |
| 53 | 1112 | | 2200 | |
| 54 | 1130 | | 2200 | |

| Bar Number | Distance to PL | Content | Length | Note |
|------------|----------------|---------|--------|------|
| 57 | 1190 | | 2200 | |
| 58 | 1211 | | 2200 | |
| 59 | 1230 | | 2200 | |
| 60 | 1250 | | 2200 | |
| 61 | 1270 | | 2200 | |
| 62 | 1290 | | 2200 | |
| 64 | 1330 | | 2200 | |
| 65 | 1350 | | 2200 | |
| 66 | 1370 | | 2200 | |
| 67 | 1390 | | 2200 | |
| 68 | 1412 | | 2200 | |
| 69 | 1431 | | 2200 | |
| 70 | 1453 | | 2200 | |
| 72 | 1493 | | 2200 | |
| 73 | 1512 | | 2200 | |
| 74 | 1532 | | 2200 | |
| 75 | 1553 | | 2200 | |
| 76 | 1571 | | 2200 | |
| 77 | 1591 | | 2200 | |

| Bar Number | Distance to CL | Content | Length | Note |
|------------|----------------|----------------|--------|------|
| SR01 | 1180 | Side Fly Bar 1 | 1440 | |
| SR02 | 1219 | Side Fly Bar 2 | 1490 | |
| SR03 | 1259 | Side Fly Bar 3 | 1490 | |
| SL01 | 1180 | Side Fly Bar 1 | 1440 | |
| SL02 | 1219 | Side Fly Bar 2 | 1490 | |
| SL03 | 1259 | Side Fly Bar 3 | 1490 | |

2 Lighting



2-1 Lighting instrument

Important : control signal were the network system.

| Item | Model Number | Position | Specification | Quantity | Frame Size | Paid Item |
|--|---|----------------------------------|---------------|----------|------------|-----------|
| Lighting control console | GrandMA 2 Light | Control Booth | | 1 | | |
| | | Auditorium | | 1 | | |
| Dimmer System | State Automation Solution | | 220V/3kW | 536ch | | |
| | | | 220V/5kW | 30ch | | |
| Ellipsoidal Reflector Spotlight 10° | Strand Leko Lite 10° | Catwalk | 750W | 14 | 305x305mm | |
| Ellipsoidal Reflector Spotlight 14° | Selecon SPX 14° | Catwalk | 750W | 19 | 158x158mm | |
| Ellipsoidal Reflector Spotlight 10° | Strand Leko Lite 10° | | 750W | 5 | 305x305mm | |
| Ellipsoidal Reflector Spotlight 14° | Selecon SPX 14° | | 750W | 15 | 158x158mm | |
| Ellipsoidal Reflector Spotlight 19° | Selecon SPX 19° | | 750W | 70 | | |
| Ellipsoidal Reflector Spotlight 26° | Selecon SPX 26° | | 750W | 70 | | |
| Ellipsoidal Reflector Spotlight 36° | Selecon SPX 36° | | 750W | 35 | | |
| Ellipsoidal Reflector Spotlight 15°/35° | Selecon SPX 15°-35° | | 750W | 35 | | |
| 2KW Fresnel Spotlight 8" | Selecon Arena Theatre 8" Fresnel 7°-60° | | 2kW | 70 | | 245x245mm |
| HMI Fresnel Spotlight 12" | ARRI D40 HMI Fresnel | | 4kW | 4 | | * |
| Parabolic Aluminized Reflector Spotlight | Kupo PL-64LB | Lamp : W x 30 · M x 30 · VN x 20 | 1kW | 80 | 254x254mm | |
| Cyc Light | Selecon Aurora CYC 4-batten | | 1kW | 12 | 305x315mm | |
| Ground Row | Selecon Aurora GroundRow 3-batten | | 1kW | 12 | | |
| Strip light | Selecon PL TR2 RGB Striplights | | | 18 | | * |
| Long Throw Follow Spot | Lycian M2 Model 2040 1.2 | | 1.2kW | 2 | | |
| Fog machine | Antari F-5D | | | 2 | | * |
| Haze machine | Antari HZ-500 | | | 2 | | * |

*Items with * mark are paid items. Please refer to the rate tables of National Kaohsiung Center for the Arts.*

2-2 Accessories

| Item | Specification | Size | Quantity |
|--------------------------|--|-------------------------|----------|
| Barn door | 2kW Fresnel | | 16 |
| IRIS | For Selecon Ellipsoidal Reflector Spotlight | | 50 |
| GOBO holder | For Selecon Ellipsoidal Reflector Spotlight | B size | 70 |
| Power Distribution Box | 8CIR CEE Form Female Plug  | | 40 |
| Multi-Cable | 16pin Multi cable | 5M | 40 |
| | | 10 M | 20 |
| | | 15 M | 10 |
| Ex-Cable | CEE16A | 1.5 M | 40 |
| | | 2 M | 60 |
| | | 3 M | 30 |
| | | 5 M | 20 |
| | | 10 M | 15 |
| | | 15 M | 15 |
| | CEE32A | 5 M | 10 |
| | | 10 M | 10 |
| Network Cable | RJ45 | 5 M | 15 |
| | | 10 M | 30 |
| Portable Sidelight Tower |  | 640(w)x960(L)x3500(H)mm | 12 |

| Key | Legend | Quantity | Brand and Model |
|-----|-----------------------------|----------|--------------------------|
| | Ellipsoidal 14° | 19 | Philips Selecon SPX 14° |
| | Ellipsoidal 10° | 14 | STRAND LEKO LITE 10° |
| | 1.2kw Long Throw Followspot | 2 | Lycian M2 Model 2040 1.2 |

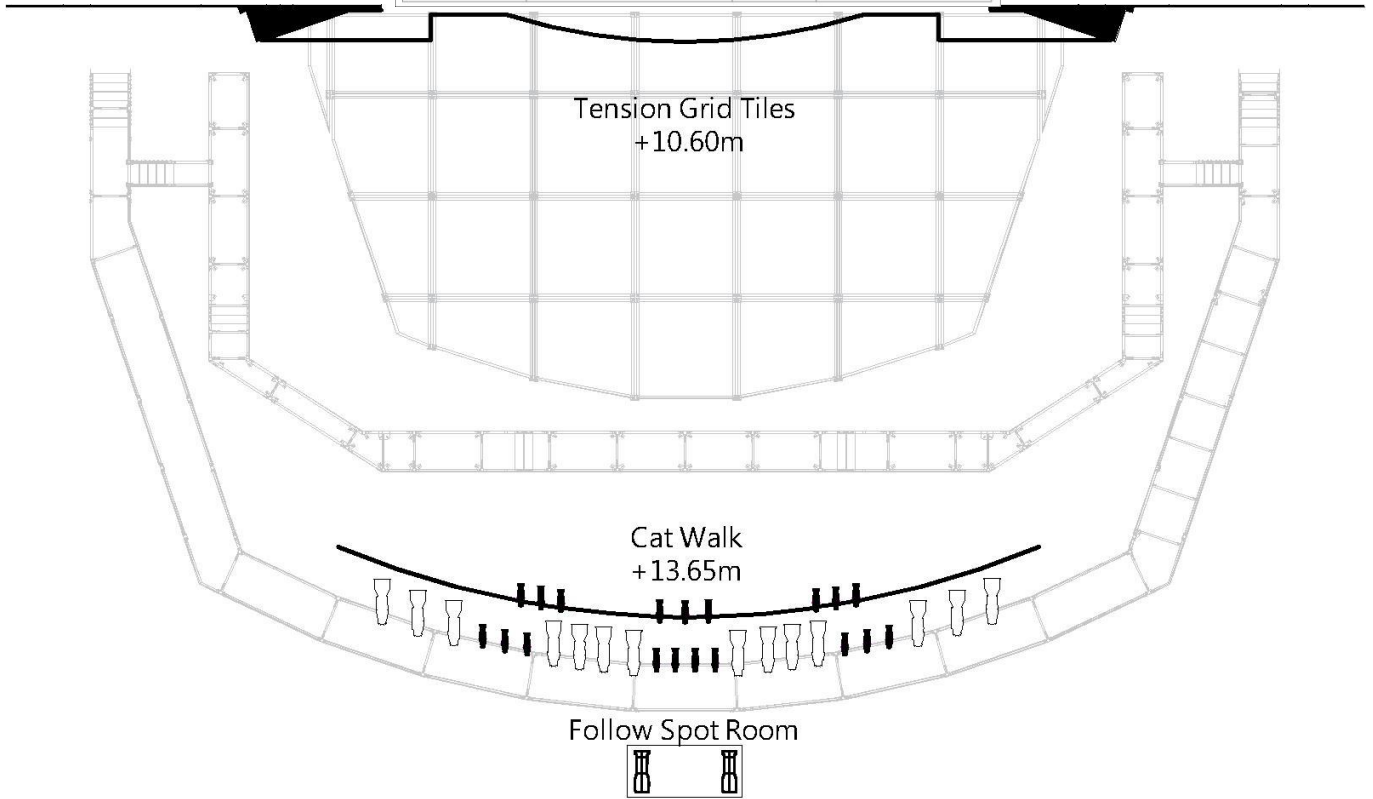

Figure 2.1- FOH Lighting Plot

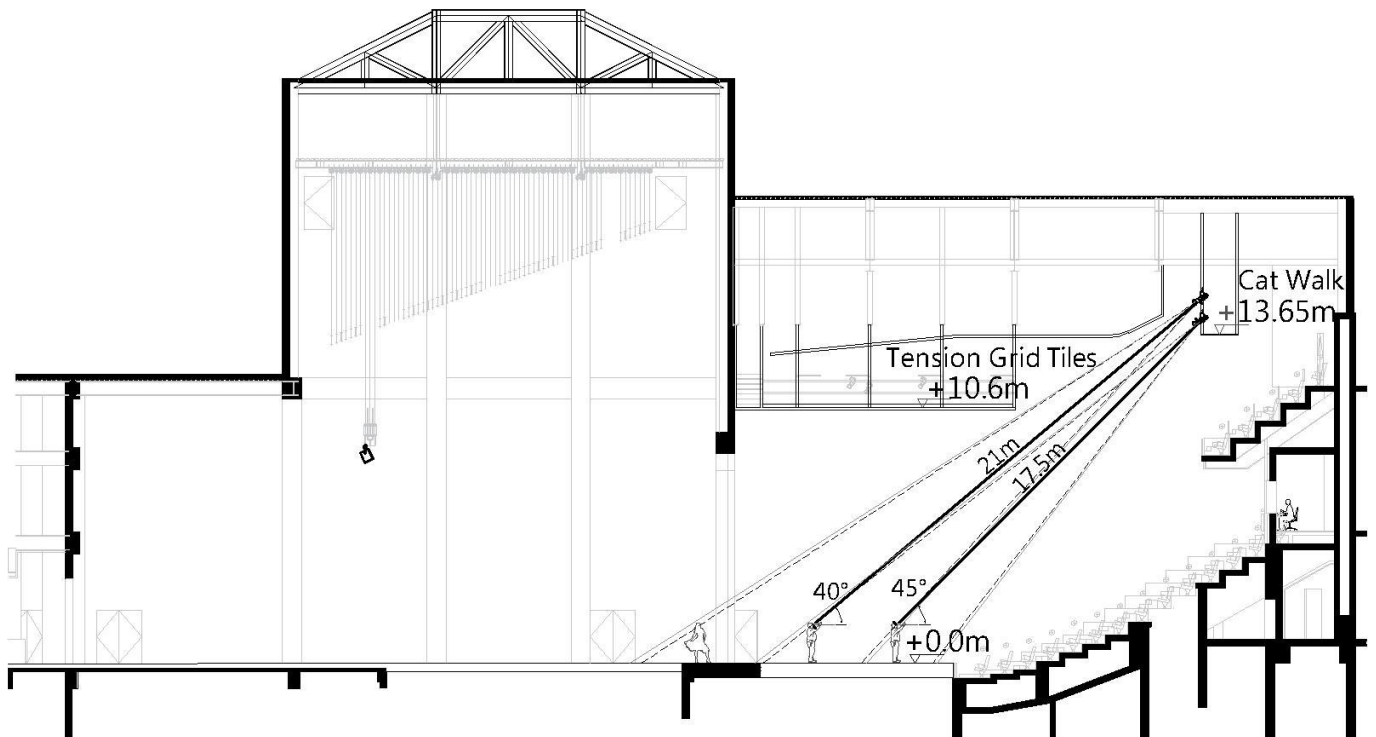

Figure 2.2- Lighting Section

2-3 Lighting Circuit**2-3-1 Stage area**

| Area and Position | Dimmer Circuit No. | Load | Network Circuit No. |
|----------------------------------|--------------------|------|---------------------|
| Trap room | 001 ~ 004 | 3kw | LN01 ~ 02 |
| | 005 ~ 008 | | |
| Down Stage/L | 009 ~ 016 | 3kw | LN05 ~ 06 |
| | 017 ~ 024 | | |
| Down Stage/R | 025 ~ 032 | 3kw | LN07 ~ 08 |
| | 033 ~ 040 | | |
| Off Stage/L | 041 ~ 048 | 3kw | LN17 ~ 18 |
| | 049 ~ 056 | | |
| Off Stage/R | 057 ~ 064 | 3kw | LN19 ~ 20 |
| | 065 ~ 072 | | |
| Rear Stage/L | 073 ~ 080 | 3kw | |
| Up Stage/L | 081 ~ 088 | | LN21 ~ 22 |
| Rear Stage/R | 089 ~ 096 | 3kw | |
| Up Stage /R | 097 ~ 104 | | LN23 ~ 24 |
| Rear Stage | 105 ~ 112 | 3kw | |
| | 113 ~ 120 | | LN25 ~ 26 |
| Adjustable Proscenium Stage/L | 121 ~ 124 | 3kw | |
| | 125 ~ 128 | | |
| | 129 ~ 132 | | |
| | 133 ~ 136 | | |
| Adjustable Proscenium Stage/R | 137 ~ 140 | 3kw | |
| | 141 ~ 144 | | |
| | 145 ~ 148 | | |
| | 149 ~ 152 | | |
| Above left stage rear Cable Reel | 153 ~ 160 | 3kw | |
| | 161 ~ 168 | | |
| | 169 ~ 176 | | |
| Gallery S.L. | 177 ~ 180 | 3kw | |
| | 181 ~ 184 | | LN55 ~ 56 |
| | 185 ~ 188 | | |
| | 189 ~ 192 | | LN57 ~ 58 |
| Gallery S.R. | 193 ~ 196 | 3kw | |
| | 197 ~ 200 | | LN59 ~ 60 |
| | 201 ~ 204 | | |
| | 205 ~ 208 | | LN61 ~ 62 |
| Gallery Rear Stage | 209 ~ 212 | 3kw | |
| | 213 ~ 216 | | LN63 ~ 64 |
| | 217 ~ 220 | | |
| | 221 ~ 224 | | LN65 ~ 66 |
| Stage Grid area | 321 ~ 328 | 3kw | |
| | 329 ~ 336 | 3kw | |
| | 337 ~ 344 | 3kw | |
| | 345 ~ 352 | 3kw | LN93 ~ 94 |
| | 353 ~ 360 | | LN95 ~ 96 |
| | 361 ~ 368 | 3kw | LN97 ~ 98 |
| | 369 ~ 376 | | |
| | 377 ~ 384 | 3kw | LN99 ~ 100 |
| | 385 ~ 392 | | |
| | 393 ~ 400 | 3kw | LN101 ~ 102 |
| | 401 ~ 408 | | |
| | 409 ~ 416 | 3kw | LN103 ~ 104 |
| | 417 ~ 424 | | |
| | 425 ~ 432 | 3kw | LN105 ~ 106 |
| 433 ~ 440 | | | |
| Down Stage/L | 441 ~ 446 | 5kw | |
| Down Stage/R | 447 ~ 452 | 5kw | |
| Up Stage/L | 453 ~ 458 | 5kw | |
| UP Stage/R | 459 ~ 464 | 5kw | |
| Rear Stage | 465 ~ 470 | 5kw | |

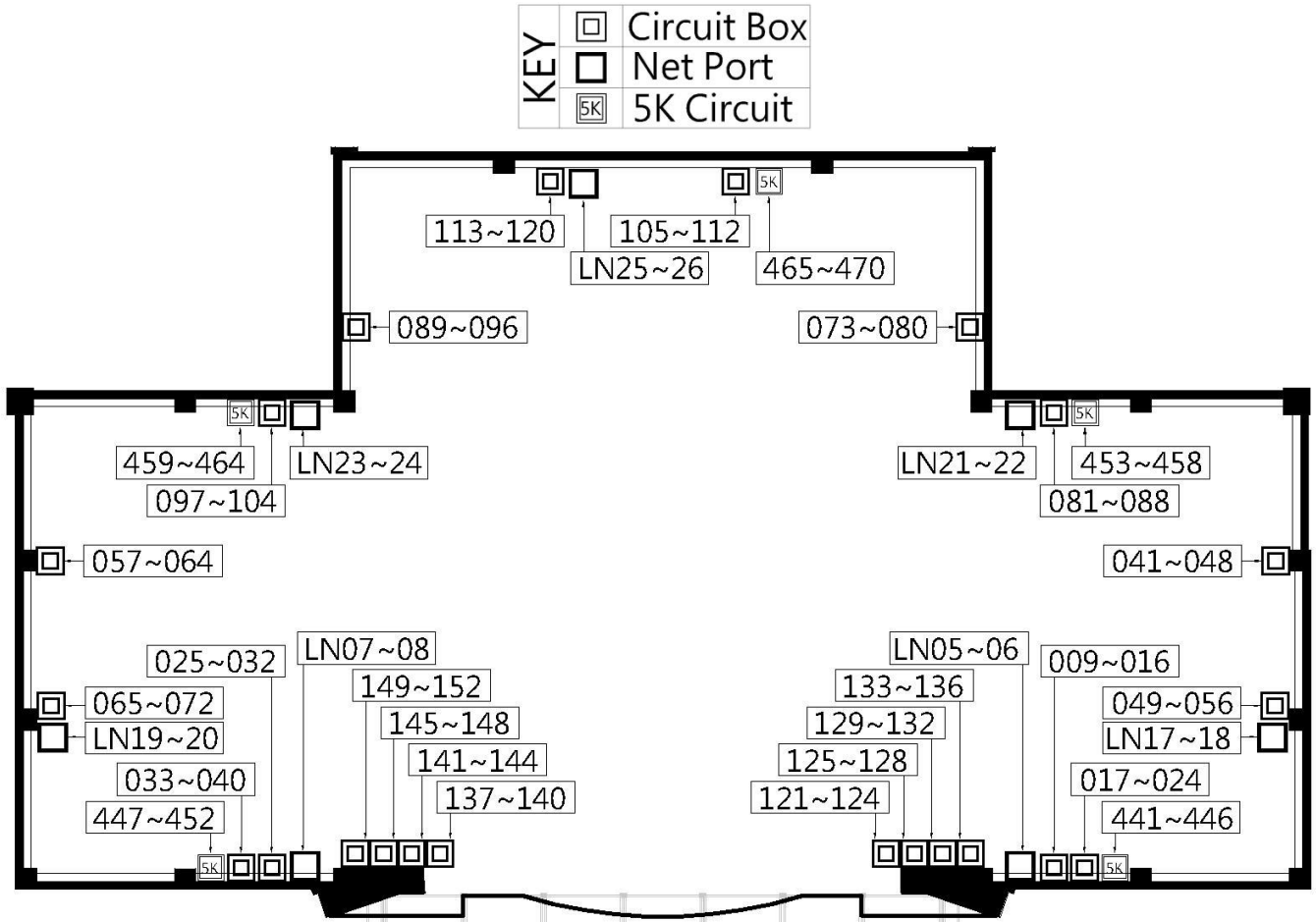

Figure 2.3.1- Stage Area Circuit Layout

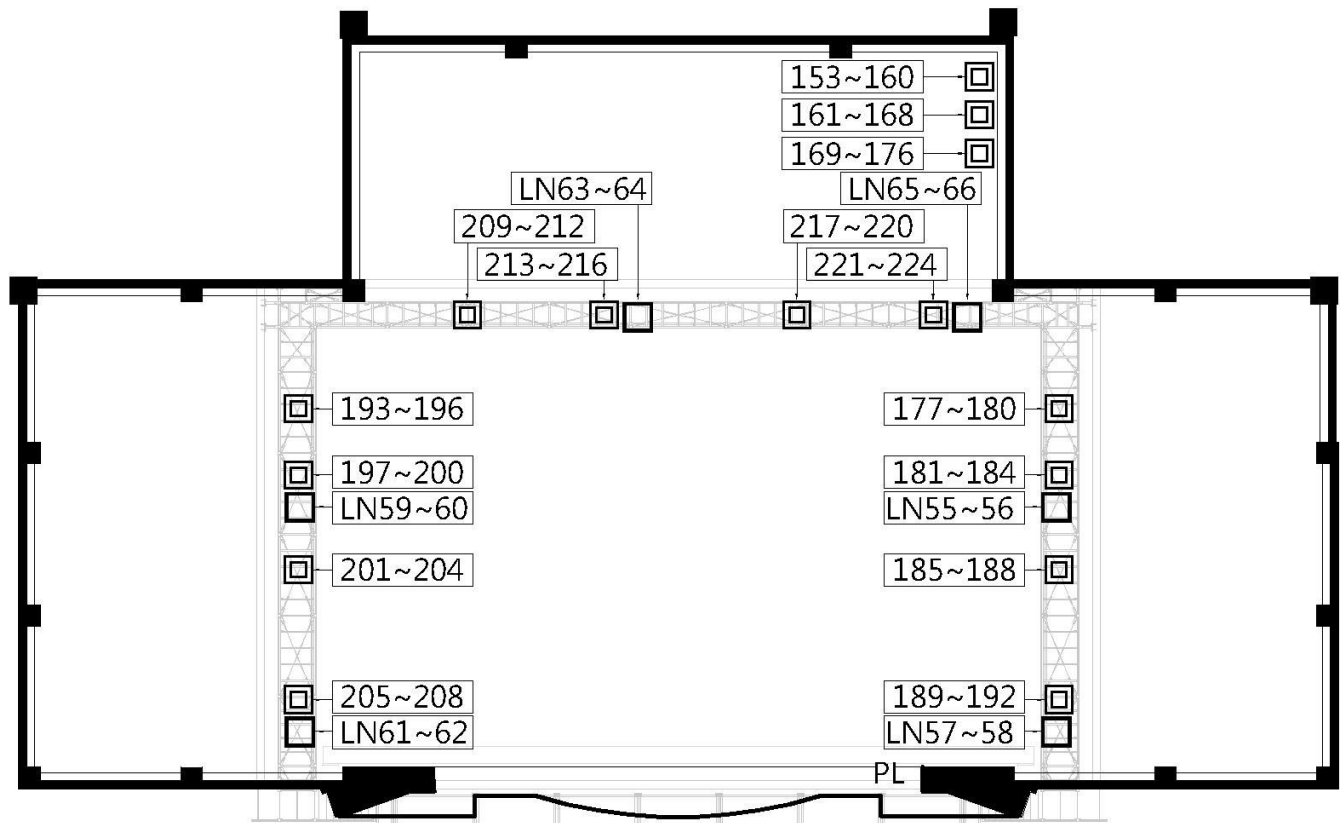

Figure 2.3.2- Gallery Circuit Layout

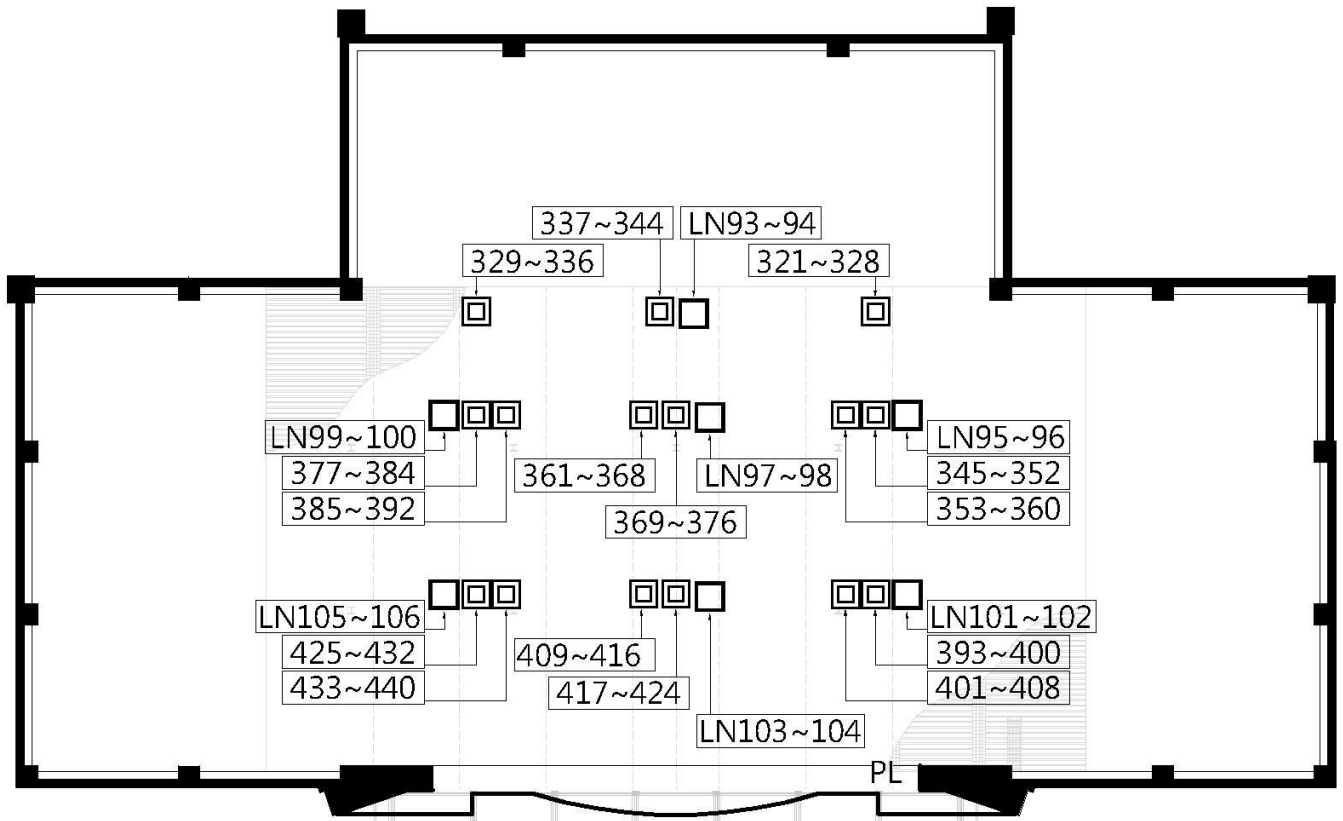

Figure 2.3.3- Grid Area Circuit Layout

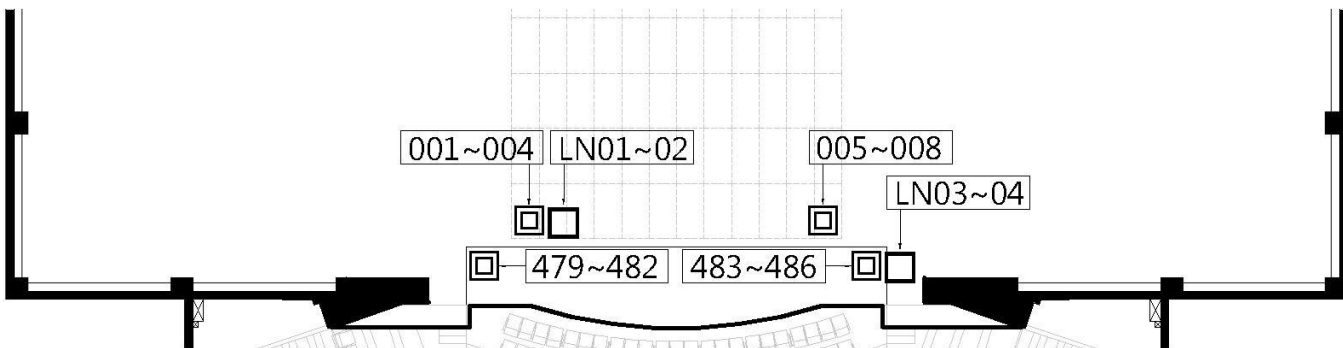

Figure 2.3.4- Stage Traps Room and Orchestra Pit Elevation Platform Circuit Layout

2-3-2 Front of House

| Area and Position | Dimmer Circuit No. | Load | Network Circuit No. |
|------------------------|--------------------|------|-------------------------------------|
| Tension Grid 1(Up) | 225 ~ 228 | 3kw | |
| Tension Grid 1(Center) | 229 ~ 232 | 3kw | |
| Tension Grid 1(Down) | 233 ~ 236 | 3kw | |
| Tension Grid 2(Up) | 273 ~ 280 | 3kw | LN71 ~ 72 |
| Tension Grid 2(Center) | 281 ~ 288 | 3kw | LN73 ~ 74 |
| Tension Grid 2(Down) | 289 ~ 296 | 3kw | LN75 ~ 76 |
| Tension Grid 3(Up) | 237 ~ 240 | 3kw | |
| Tension Grid 3(Center) | 241 ~ 244 | 3kw | |
| Tension Grid 3(Down) | 245 ~ 248 | 3kw | |
| Tension Grid 4(Up) | 249 ~ 252 | 3kw | |
| Tension Grid 4(Center) | 253 ~ 256 | 3kw | |
| Tension Grid 4(Down) | 257 ~ 260 | 3kw | |
| Tension Grid 5(Up) | 297 ~ 304 | 3kw | LN77 ~ 78 |
| Tension Grid 5(Center) | 305 ~ 312 | 3kw | LN79 ~ 80 |
| Tension Grid 5(Down) | 313 ~ 320 | 3kw | LN81 ~ 82 |
| Tension Grid 6(Up) | 261 ~ 264 | 3kw | |
| Tension Grid 6(Center) | 265 ~ 268 | 3kw | |
| Tension Grid 6(Down) | 269 ~ 272 | 3kw | |
| Auditorium aisle | 471 ~ 474 | 3kw | LN37 ~ 38 |
| | 475 ~ 478 | | LN39 ~ 40 |
| Orchestra Pit Lift | 479 ~ 482 | 3kw | LN03 ~ 04 |
| | 483 ~ 486 | | |
| Balcony Rail S.R. | 487 ~ 489 | 3kw | LN67 ~ 68 |
| | 490 ~ 492 | | |
| | 493 ~ 495 | | |
| | 496 ~ 498 | | |
| | 499 ~ 501 | | |
| | 502 ~ 504 | | |
| | 505 ~ 507 | | |
| | 508 ~ 510 | | |
| Balcony Rail S.L. | 511 ~ 513 | 3kw | LN69 ~ 70 |
| | 514 ~ 516 | | |
| | 517 ~ 519 | | |
| | 520 ~ 522 | | |
| | 523 ~ 525 | | |
| | 526 ~ 528 | | |
| | 529 ~ 531 | | |
| | 532 ~ 534 | | |
| Catwalk | 535 ~ 538 | 3kw | LN83 ~ 84 LN85 ~ 86 LN87 ~ 88 |
| | 539 ~ 542 | | |
| | 543 ~ 546 | | |
| | 547 ~ 550 | | |
| | 551 ~ 554 | | |
| | 555 ~ 558 | | |
| | 559 ~ 562 | | |
| | 563 ~ 566 | | |

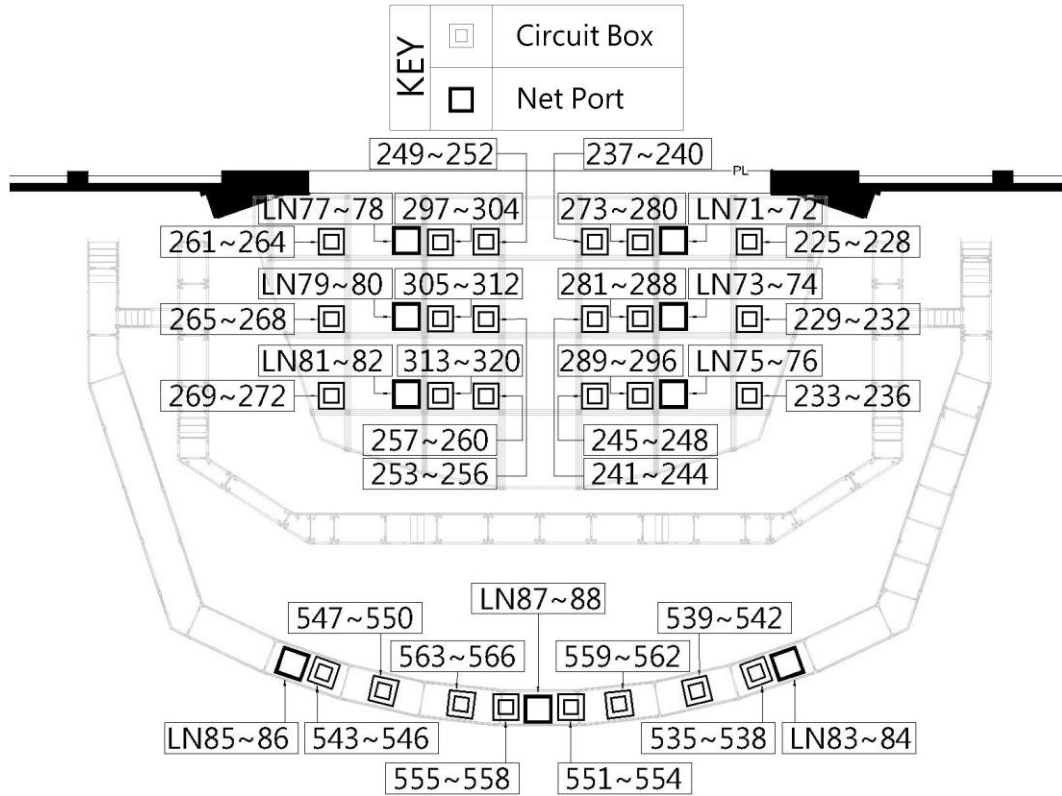

Figure 2.3.5- Tension Grid and Catwalk Circuit Layout

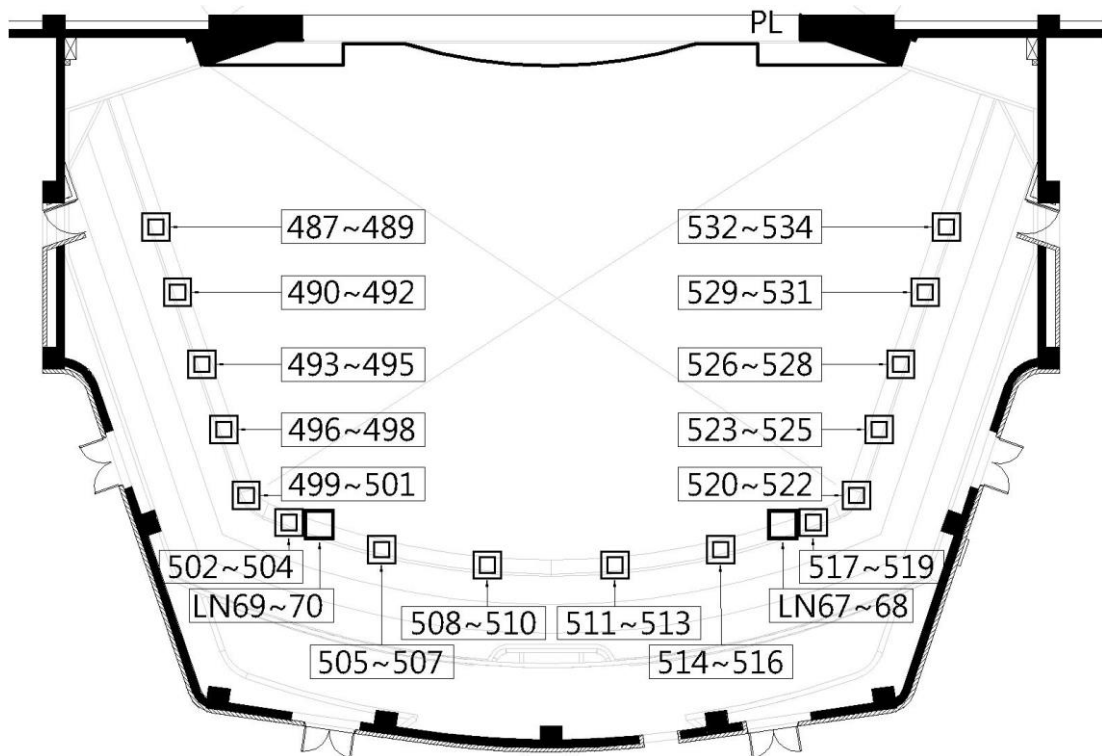

Figure 2.3.6- Balcony Rail Circuit Layout

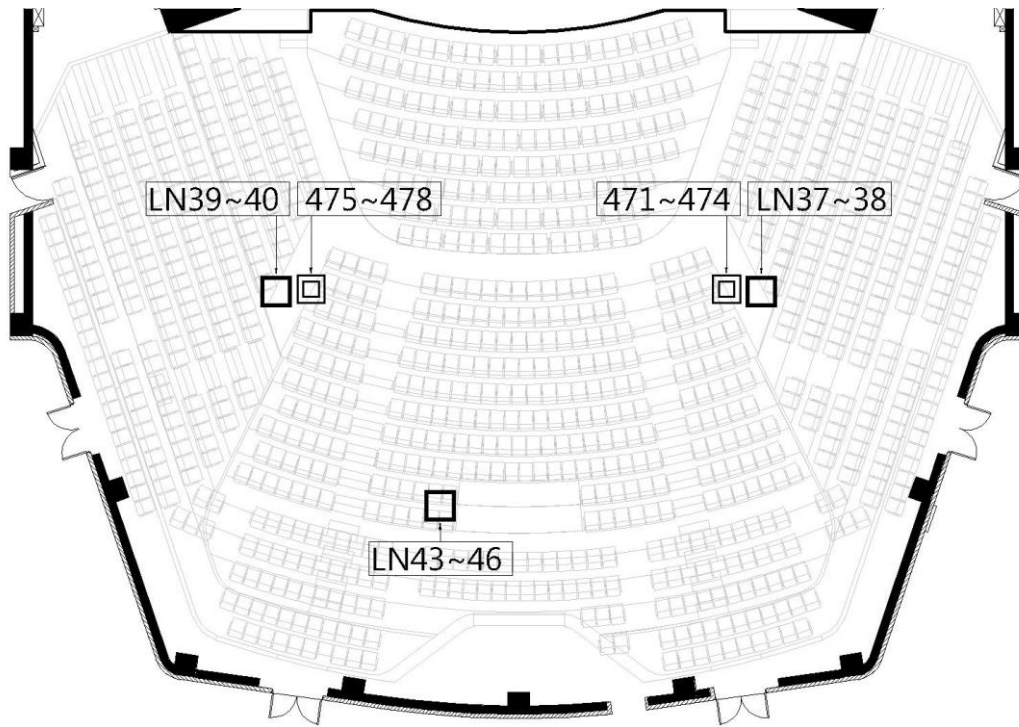

Figure 2.3.7- Auditorium Circuit Layout

2-4 Portable Lift

Brand and Model : Snorkel UL-40 (rechargeable)

Maximum height: 12.1m

Maximum weight: 136kg

Quantity: 1

2-5 Additional Power Supply

| Function | Position | Specifications | Quantity |
|----------|--|--|-------------------|
| Stage | | 3 ϕ 4W+G 380V/220V /60Hz (CEE 125A/3P+N+PE) | 1 / 1 |
| Light | Down Stage Left / Right | 3 ϕ 4W+G 220V/120V /60Hz (Camlock 250A) | 1 / 1 |
| Sound | | 3 ϕ 4W+G 220V/120V /60Hz (Camlock 100A) | 1 / 1 |
| Stage | Stage Left / Stage Right / | 3 ϕ 4W+G 380V/220V /60Hz (CEE 125A/3P+N+PE) | 2 / 2 / 1 / 1 / 2 |
| Light | Up Stage Left / Up Stage Right /Rear Stage | 3 ϕ 4W+G 220V/120V /60Hz (Camlock 250A) | 2 / 2 / 1 / 1 / 2 |



Figure 2.4- Additional Power Supply

2-6 House Light / Working Light / Blackout

Work lights

Work lights provided white and blue light mode, and the control switch is located on the stage manager' s Desk.

Lighting area: Stage, stage Traps room, under Elevation Platform (include machine pit), Orchestra Pit, Gallery, Tension Grid, Stage Grid area, Cat walk and seat storage room.

Auditorium lights

Auditorium lights consists houselights and step lights, which can be separately controlled and dimmed. The control panel is located on the stage manager' s Desk and lighting control room.

Blackout

In accordance with government Fire Services Act, there are many of emergency lights in the venue. We cannot extinguish the emergency lighting for any performance, there will be the minimal lighting levels in the auditorium and backstage areas.

3 Audio/Video-Systems

3-1 Audio Facilities

| Item | Quantity | Brand and Model | Paid Item |
|--|----------|--|-----------|
| Digital mixer (Movable) | 1 | Soundcraft Vi4 | * |
| Main speaker (Front center channel) | 4 | Renkus-Heinz STX2/94 | |
| Main speaker(Rear center channel) | 3 | Renkus-Heinz STX2/64 | |
| Main speaker(Left and right channels) | 4 | Renkus-Heinz STX2/64 | |
| Left and right channel auxiliary speaker | 2 | Renkus-Heinz STX2/94 | |
| Subwoofer | 4 | Renkus-Heinz BPS15-2K | |
| Surround speakers | 16 | Renkus-Heinz PNX81/12 | |
| Stage front speakers | 12 | Renkus-Heinz CFX 41 | |
| 12" Stage Active speaker | 2 | Renkus-Heinz PN121/9 | |
| 15" Stage Active speaker | 2 | Renkus-Heinz PN151/9 | |
| 12" Stage Active speaker | 8 | Renkus-Heinz PN121M/12 | * |
| 6.5" Stage Active speaker | 6 | Renkus-Heinz PN61 | * |
| Dual channel Equalizer | 4 | BSS FCS960 | * |
| Digital I/O Fiber Module | 2 | Studer D21M | |
| Follow RM. speakers | 2 | Dynaudio BM compact MkIII | |
| Movable auxiliary speaker | 2 | Renkus-Heinz PNX151T/9A Renkus-Heinz DRS18-1B LabGruppen PLM10000Q | |

*Items with * mark are paid items. Please refer to the rate tables of National Kaohsiung Center for the Arts.*

3-2 Control Room

| Item | Quantity | Brand and Model | Paid Item |
|--------------------------------|----------|-----------------------------|-----------|
| Main Digital mixer | 1 | Studer VISTA 5 M3/42 | |
| Digital I/O Fiber Module | 1 | Studer D21m | |
| CD Player | 1 | Tascam CD-500B | * |
| CD-R Player | 1 | Tascam CD-RW 901 MKII | * |
| Dual channel Digital Effects | 2 | Eventide Eclipse V4 | |
| Multitrack Recording equipment | 1 | JoeCo BBR1D+2.5" USB 1TB HD | * |
| Dual track Hard disk recorder | 1 | Tascam DA 3000 | * |
| Active speaker | 2 | Dynaudio BM12 MkIII | |

*Items with * mark are paid items. Please refer to the rate tables of National Kaohsiung Center for the Arts.*

3-3 Stage Manager' s Console

The stage manager' s console is equipped with a near-field monitor speaker,stage video monitors ,synchronous show screens with lighting and flying system controller ,communication system and live announcements to individual space in backstage.

3-4 Machine Room

| Item | Quantity | Brand and Model | Note |
|------------------------------|----------|---------------------------------|------|
| Digital Audio Management | 1 | Studer D21M (Studer Score Live) | |
| Audio Control Manager Switch | 1 | HP 1410-24 | |
| Digital I/O Fiber Module | 1 | Studer D21M | |

3-5 Microphone

| Item | Quantity | Brand and Model | Paid Item |
|---|----------|---------------------------------|-----------|
| Dynamic microphone | 4 | Audio Technica AE4100 | * |
| Condenser microphone | 4 | Audio Technica AE5400 | * |
| Dynamic microphone | 8 | Audio Technica ATM250 | * |
| Cardioid Condenser microphone | 6 | Audio Technica AT4021 | * |
| Gradient Condenser microphone | 4 | Audio Technica BP4073 | * |
| Cardioid Condenser Boundary Microphone | 4 | Audio Technica U851R | * |
| Stage reception Microphone | 4 | DPA 4017B / DPA UA 0836 Holders | |
| Hypercardioid Condenser microphone | 6 | AKG CK63-ULS+C480B | * |
| Cardioid condenser microphone | 6 | AKG CK61-ULS+C480B | * |
| Wireless microphone | 4 | Sennheiser SKM500G3+MME865 | * |
| Mini wireless microphone | 12 | Sennheiser SK500G3+MKE2 | * |
| Single channel wireless microphone receiver | 16 | Sennheiser EW500G3 | |
| Wireless microphone wave antenna | 2 | Sennheiser AD3700 | |
| Wave antenna distributor | 3 | Sennheiser ASA1 | |
| Microphone Stand Cross bar | 12 | K&M 210/6 | |
| Microphone Stand Telescopic bar | 12 | K&M 210/8 | |
| Microphone dwarf with telescopic crossbar | 4 | K&M 259 | |

*Items with * mark are paid items. Please refer to the rate tables of National Kaohsiung Center for the Arts.*

3-6 Communications

| Item | Quantity | Brand and Model | Paid Item |
|--|----------|--|-----------|
| Intercom host machine (Matrix 32 x 32) | 1 | Clear-Com Eclipse HX-Delta | |
| Phone interface | 1 | Clear-Com TEL-14 | |
| System interface | 1 | Clear-Com Helixnet HMS-4X | |
| Double circuit intercom | 8 | Clear-Com Helixnet HBP-2X | |
| Fixed intercom microphone/ speak | 2 | Clear-Com V12PDXY 110 / 340 Clear-Com V12PDDXY 110 / 340 | |
| Single head receiver microphone | 8 | Clear-Com CC-300 | |
| Double head receiver microphone | 4 | Clear-Com CC-400 | |
| Telephone intercom | 2 | Clear-Com HS-6 | |
| Digital Wireless Intercom set | 8 | 1. Portable wireless sub-station / Clear-Com FS-BP 2. Single-ear headset / Clear-Com CC-300 | * |

*Items with * mark are paid items. Please refer to the rate tables of National Kaohsiung Center for the Arts.*

3-7 Locations of Communications

Each floor is paired with intercom system, 34 units in total.

| No. | Floor | Location |
|-----|-------|---------------------------|
| 1 | B1F | Orchestra area |
| 2 | | Orchestra area |
| 3 | | Orchestra area |
| 4 | | Stage trap area |
| 5 | | Rest room |
| 6 | 1F | Stage left |
| 7 | | Stage right |
| 8 | | Upstage left |
| 9 | | Upstage right |
| 10 | | Rear stage |
| 11 | | Stage left proscenium |
| 12 | | Stage right proscenium |
| 13 | | Loading Dock |
| 14 | | Left downstage |
| 15 | | Right downstage |
| 16 | | Dressing room 01 |
| 17 | | Dressing room 02 |
| 18 | | Dressing room 03 |
| 19 | | Dressing room 04 |
| 20 | | Sound room |
| 21 | 2F | Auditorium control area |
| 22 | | Control room |
| 23 | | Control room |
| 24 | 2MF | Stage right work corridor |
| 25 | | Stage left work corridor |
| 26 | | Rear stage work corridor |
| 27 | | Floor leading edge |
| 28 | 3F | Right tension |
| 29 | | Left tension |
| 30 | | Dimmer room |
| 31 | | Amplifier room |
| 32 | 4F | Follow room |
| 33 | | Winch room |
| 34 | | Catwalk |

3-8 Stage Cameras and Video Surveillance Systems

Stage monitors are installed in right and left stage entrances, first, second, and third floor lobbies, master and secondary control rooms, dressing rooms and green rooms.

| Item | Quantity | Brand and Model | Paid Item |
|-----------------------------------|----------------|---|-----------|
| Camera (2/3 inch 3CCD) | 1 | Panasonic AW-HE870 Panasonic LZ20M85G | |
| Remote control | 1 | Panasonic AW-RP50 | |
| Switcher | 1 | Panasonic AW-RP120 | |
| Camera | 1 | Panasonic AW-HE60SN | |
| Infrared camera | 1 | Ricoh STG-4 Pentax TS15ZAME | |
| Switcher | 2 | Ricoh STG-4 | |
| Video matrix switch | 1 | Kramer Aspen 3232HD-3G | |
| Quad image processor | 1 | Kramer MV-6 | |
| Signal converter (HD-SDI to HDMI) | 12 | Kramer FC-331 | |
| 4x1 Video Selector (HD-SDI 4x1) | 1 | Sierra Video SVG | |
| Mixer circuit | Circuit / Show | | * |
| Video recording | Show | Fixed camera for stage panoramic view recording, only suitable for archived copy. | |

Items with * mark are paid items. Please refer to the rate tables of National Kaohsiung Center for the Arts.

3-9 Paging Systems

Backstage Paging Systems

There are four venues individually Backstage Paging Systems in National Kaohsiung Center for the Arts. For Concert Hall paging available to all dressing rooms, green rooms, office and passage, it can also available paging to separately 5 zones. The Paging and Program position is located on the stage manager' s console.

Zone 1 : 1234 Green Room-01 、 1235 Green Room-02 、 B1137 Usher's room-07 、 B1138 Usher's room-08

Zone 2 : 1254 Green Room 、 B1130 Dressing Room-05 、 B1132 Dressing Room-06 、 B1134 Dressing Room-07 、 B1141 Dressing Room-08 、 B1146 Dressing Room-09

Zone 3 : Passage B1126

Zone 4 : Passage (1230 、 1240 、 1233 、 1255 、 1256 、 1257)

Zone 5 : 1244 Green Room-01 、 1245 Dressing Room-01 、 1247 Green Room-02 、 1248 Dressing Room-02 、 1250 Dressing Room-03 、 1252 Dressing Room-04 、 1255A Office

3-10 Projector

| Item | Quantity | Brand and Model | Paid Item |
|--------------------------|----------|---|-----------|
| 20000 Ansi Projector | 2 | Digital Projection Titan Super Quad 1080 p 3D | * |
| 0.67:1 fixed HB Lens | 2 | 105-607 1.1m-10m | |
| 1.87-2.56:1 zoom HB Lens | 2 | 105-611 4m-24m | |
| 2.56-4.16:1 zoom HB Lens | 2 | 105-612 9.1m-45m | |

※With projector scaffolding of back projection.

*Items with * mark are paid items. Please refer to the rate tables of National Kaohsiung Center for the Arts.*

3-11 Projector connections

| Video & Computer | | | Communication & Control | | |
|-------------------|----------------|-----|-------------------------|-------------------|-----|
| Type | Connector | Qty | Type | Connector | Qty |
| Qty DVI-D / DVI-A | DVI-I | 1 | 3D Sync Out | BNC | 1 |
| HDMI 1.3 | HDMI | 1 | 3D Sync In | BNC | 1 |
| 3G-SDI | BNC | 1 | LAN | RJ45 | 1 |
| VGA/ Analog RGB | 15-pin D-Sub | 1 | RS232 | 9-pin D Sub | 1 |
| Component Video | 4 x BNC | 1 | Wired Remote In | 3.5mm Stereo Jack | 1 |
| S-Video | 4-pin Mini DIN | 1 | Wired Remote Out | 3.5mm Stereo Jack | 1 |
| Composite Video | RCA | 1 | Update Port | RJ45 | 1 |
| Composite Video | BNC | 1 | Service Port | USB Type B | 1 |

3-12 Subtitle

| Item | Quantity | Brand and Model | Paid Item |
|-------------------------|------------------------|------------------------|-----------|
| Subtitle display screen | 1 / 12 pieces in total | Panasonic(TH-55LFV70W) | * |

** Items with * mark are paid items. Please refer to the rate tables of National Kaohsiung Center for the Arts.*

4 Backstage

4-1 Dressing Room and Green Room

| No. | Floor | Room No. | Name | Capacity | Notes |
|-----|-------|----------|----------------------|----------|--|
| 1 | 1 | 1029 | Green room 01 | 20 | Includes upright piano, dressing mirror, table and chairs. |
| 2 | | 1034 | Dressing room 01 | 3 | Includes mirror, table and chairs, toilet and shower |
| 3 | | 1036 | Dressing room 02 | 3 | Includes mirror, table and chairs, toilet and shower |
| 4 | | 1038 | Dressing room 03 | 3 | Includes mirror, table and chairs, toilet and shower |
| 5 | | 1040 | Dressing room 04 | 3 | Includes mirror, table and chairs, toilet and shower |
| 6 | | 1042 | Green room | 10 | Includes table and chairs. |
| 7 | | 1050 | Green room | 10 | Includes table and chairs. |
| 8 | | 1050A | Green room | 10 | Includes table and chairs. |
| 9 | | 1052 | Quick changing Booth | 2 | Includes dressing mirror, table and chairs. |
| 10 | | 1054 | Dressing room 05 | 8 | Includes mirror, table and chairs, toilet and shower |
| 11 | | 1056 | Dressing room 06 | 8 | Includes mirror, table and chairs, toilet and shower |
| 12 | B1 | B1020 | Dressing room 07 | 26 | Includes mirror, table and chairs, toilet and shower |
| 13 | | B1025 | Green room 02 | 20 | Includes dressing mirror, table and chairs. |
| 14 | | B1026 | Dressing room 08 | 14 | Includes mirror, table and chairs, toilet and shower |
| 15 | | B1028 | Dressing room 09 | 14 | Includes mirror, table and chairs, toilet and shower |
| 16 | | B1043 | Dressing room 10 | 12 | Includes mirror, table and chairs and toilet |
| 17 | | B1043A | Dressing room 11 | 12 | Includes mirror, table and chairs and toilet |

4-2 Orchestra Facilities

| No. | Item | Quantity | Notes |
|-----|------------------------|----------|---|
| 1 | Chair | 40 | |
| 2 | Ensemble stool | 3 | |
| 3 | Conductor' s chair | 1 | |
| 4 | Music stand | 40 | |
| 5 | Music stand light | 40 | White light, two brightness mode |
| 6 | Conductor' s podium | 1 | WENGER Base podium:1.09 x 0.97 x 0.15 m Upper podium:0.81 x 0.97 x 0.15 m |
| 7 | Conductor' s stand | 1 | WENGER Desk is 0.69(w)x0.51(d)m Desk height is adjustable from 0.76-1.2m |
| 8 | Percussion table stand | 1 | |
| 9 | Endpin stopper | 2 | |
| 10 | Acoustic shield | 1 | |

4-3 Pianos (shared between four theatres)

| No. | Item | Brand | Model Number | Quantity | Notes |
|-----|--------------------------|-----------------|-------------------------|----------|-------|
| 1 | Model-D Concert grand | Steinway & Sons | D-274 | 3 | * |
| 2 | Concert grand | FAZIOLI | F308 | 1 | * |
| 3 | Grand Piano | YAMAHA | C7XPE | 1 | * |
| 4 | Grand Piano | KAWAI | SK-6L | 1 | * |
| 5 | Celesta | Schiendmayer | 5 ½ Octave Studio model | 1 | * |
| 6 | Harpsichord | J.C.NEUPERT | Hemsch | 1 | * |

*Items with * mark are paid items. Please refer to the rate tables of National Kaohsiung Center for the Arts.*

Important : *Pianos shared with four venues ,booking in advance is required.*

WeiWuYing's contract-signed piano technician must tune all pianos before performance. (Piano hire fees do not include tuning costs)

4-4 Loading Dock / Scenery Shipping Path / Loading Flow

4-4-1 West Dock

Playhouse and Opera House use the West Dock for loading and unloading. The dock is equipped with three hydraulic dock leveler that can be adjusted according to the required height.

Dock Dimension

Big loading dock: 7.25m (width) x 4.38m (height)

Small loading dock: 3.5m (width) x 4.38m (height)

Loading entrance and exit: 4.38m (height from floor to top)
3.8m (height from dock to grid area)

Stage entrance and exit: minimum 4m (width) x 3.4m (height)

Height from dock to floor: 0.98m

4-4-2 Handling equipment

Platform Trolley x20 (1.2m x2.4m)

2.5mt Electric Forklift x1

1.5mt Stand-Up Automatic Electric Forklift x1

3mt Manual Hydraulic Pallet Jack x2

East Dock Handling equipment

The East Dock equipment is mainly used by Recital Hall and Concert Hall. In need, please requests in advance.

Platform Trolley (with handle)x10 (0.9m x1.8m)

1.5mt Stand-Up Automatic Electric Forklift x1

3mt Manual Hydraulic Pallet Jack x1

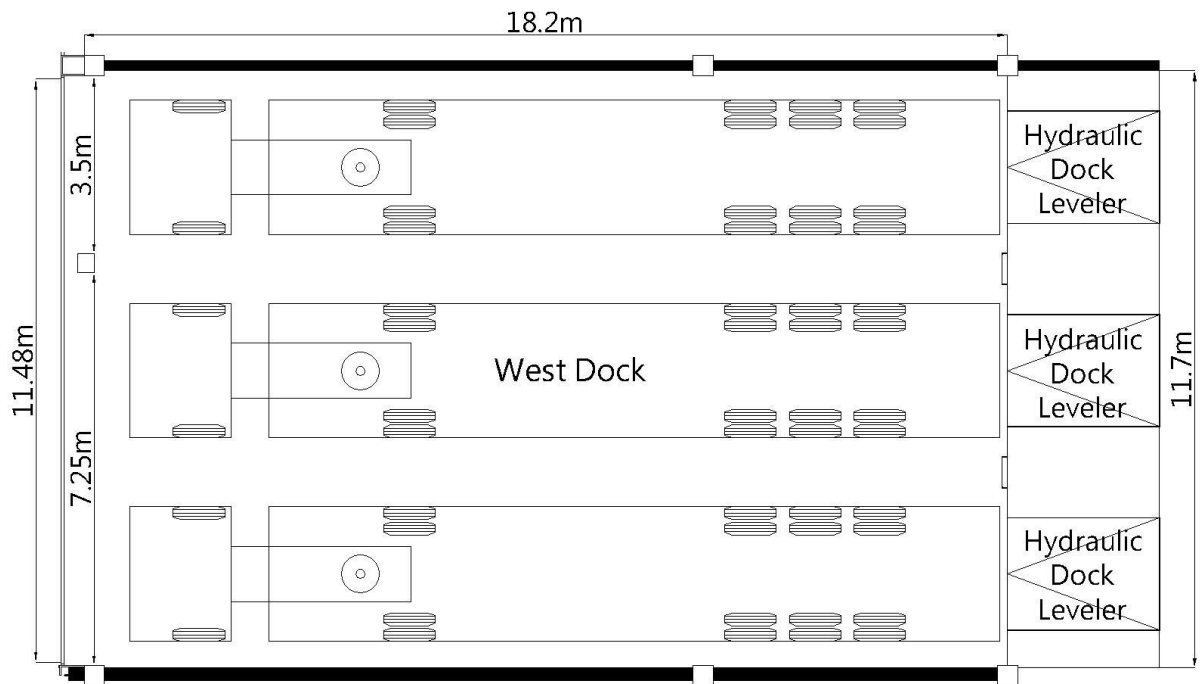

Figure 4.1- West Loading Dock Plan

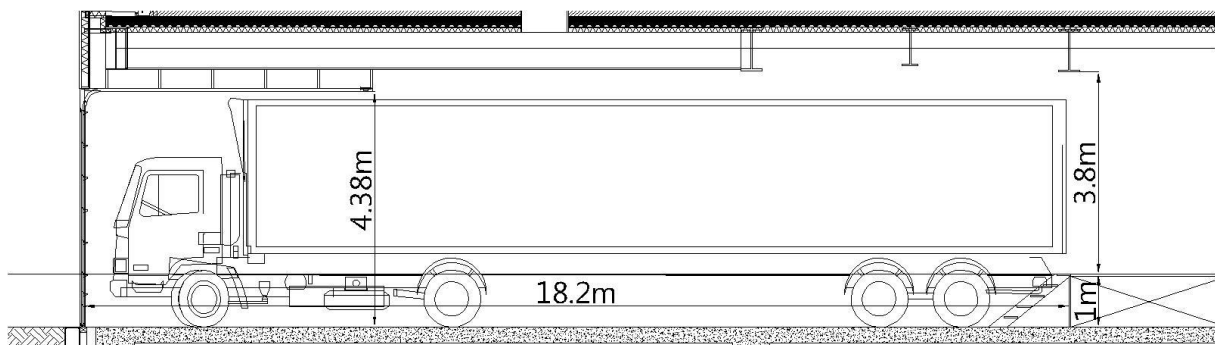

Figure 4.2- West Loading Dock Section

4-4-3 Loading Flow

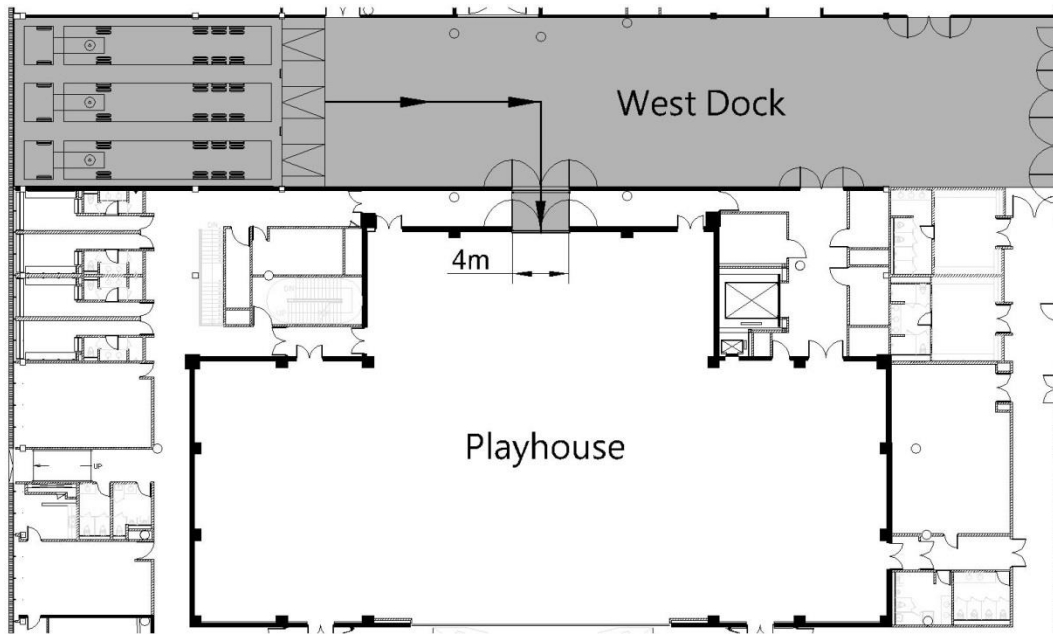

Figure 4.3- Loading Flow

4-4-4 Hydraulic Dock Leveler

Capacity: 22.6mt

Area: 198cm (width) x 221.9cm (length)

Elevation: +/- 30.5cm

Quantity: 3

4-5 Other Facilities

4-5-1 Rehearsal Rooms

There is no rehearsal studio dedicated to the Playhouse. Additional rehearsal space is limited across the WeiWuYing. There are 13 different function and accommodated rehearsal studios, these available for hire between four major theatres. Requests should be discussed well in advance to determine availability. The hire fees please refer to the rate tables of National Kaohsiung Center for the Arts.

| Room No. | Name | Dimension (Length x Width x Height / m) | Notes |
|----------|-----------------------|--|--|
| B313 | Orchestra Studio | 23.2×18.1×7.8 | 1. fixed auditorium< 84seats> 2. Grand Piano ,Chair , Ensemble stool 3. Wooden floor 4. Sound absorption curtain |
| B304 | Chorus Rehearsal Room | 17×11.2×8.8 | 1. Grand Piano ,Chair , Ensemble stool 2. Wooden floor 3. Sound absorption curtain |
| 1171 | Rehearsal Studio-01 | 13.1×21.5×11.7 | 1. Grand Piano 2. Wooden floor covered black color dance floor 3. Wall mount glassless mirrors x 1 side Opera House rehearsal room |
| 1182 | Rehearsal Studio-02 | 12.8×22.3×4 | 1. Wooden floor covered gray color dance floor 2. Sound absorption wall x 2 side 3. Wall mount glassless mirrors x 2 side |
| 1184 | Rehearsal Studio-03 | 12.8×22.3×4 | 1. Grand Piano 2. Wooden floor covered gray color dance floor 3. Sound absorption wall x 2 side 4. Wall mount glassless mirrors x 2 side |
| 1186 | Rehearsal Studio-04 | 12.8×22.3×4 | 1. Grand Piano 2. Wooden floor ,black color dance floor 3. Wall mount glassless mirrors x 2 side 4. Fixed Ballet barre on the single sided wall mirror x 2 |
| | | 6.6×8.8 ×3 | Rehearsal Studio-04 use only Green Room-01(With dressing room) |
| 1192 | Rehearsal Studio-05 | 12.8×22×4 | 1. Grand Piano 2. Wooden floor , black color dance floor 3. Wall mount glassless mirrors x 2 side 4. Fixed Ballet barre on the single sided wall mirror x 2 |
| | | 6.6×8.8 ×3 | Rehearsal Studio-05 use only Green Room-02(With dressing room) |
| B1111 | Rehearsal Studio-06 | 8.5×9×2.7 | 1. Upright piano ,Chair , Music stand 2. Wooden floor 3. Sound absorption wall |
| B1112 | Rehearsal Studio-07 | 6.3×5.2×2.7 | 1 Chair , Music stand 2. Wooden floor 3. Sound absorption wall |
| B1113 | Rehearsal Studio-08 | 5.7×8.4×3.3 | 1. Chair , Music stand 2. Wooden floor 3. Sound absorption wall |
| B1114 | Rehearsal Studio-09 | 5.7×5.6×3.3 | 1. Chair , Music stand 2. Wooden floor 3. Sound absorption wall |
| B1115 | Rehearsal Studio-10 | 5.7×5.6×3.3 | 1. Chair , Music stand 2. Wooden floor 3. Sound absorption wall |
| B1116 | Rehearsal Studio-11 | 5.7×5.6×3.3 | 1. Chair , Music stand 2. Wooden floor 3. Sound absorption wall |

4-5-2 Carpentry Shop / Metal Shop / Costume Shop / Laundry Room

National Kaohsiung Center for the Arts is equipped with basic production facilities, include Carpentry Shop, Metal Shop, Costume Shop, and laundry rooms. Those for hire between four major theatres .The hire fees please refer to the rate tables of National Kaohsiung Center for the Arts.

| Room No. | Name | Dimension (Length x Width x Height / m) | Notes |
|----------|-----------------|--|---|
| 1002 | Carpentry Shop | 11.9×19.7×3 | Basic wood crafts and electrical tools |
| 1002A | Metal Shop | 8.9×5.8×3 | General welding facilities for repairs |
| 1165 | Costume Shop-01 | 5.9×10.2×3 | Basic facilities for the maintenance of costume; Sewing machine, overlock machine and steam / iron equipment |
| 1181 | Costume Shop-02 | 5.8×11.8×3 | |
| 1163 | Laundry Room-01 | 5.8×4.9×3 | Washing machine, tumble dryers, sink and clothes folding table |
| B1019 | Laundry Room-02 | 6×8.2×3 | |